

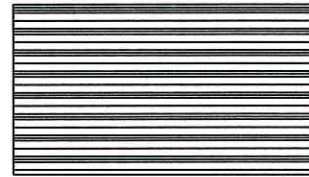

an Andersen Company  
2045 Kerper Blvd., Dubuque, IA 52004-1072

## LVL WOOD MULLION



2" x 3.5" LVL WOOD MULLION

### GENERAL NOTES:

- THIS PRODUCT HAS BEEN EVALUATED AND IS IN COMPLIANCE WITH THE FLORIDA BUILDING CODE EXCLUDING THE "HIGH VELOCITY HURRICANE ZONE".
- WOOD BUCKS BY OTHERS, MUST BE ANCHORED PROPERLY TO TRANSFER LOADS TO THE STRUCTURE AND BE REVIEWED BY THE BUILDING OFFICIAL.
- MULLION ANCHOR EMBEDMENT TO BASE MATERIAL SHALL BE BEYOND WALL DRESSING OR STUCCO.
- SEPARATE PRODUCT APPROVALS FOR EACH GLAZING PRODUCT USED WITH THESE MULLIONS MUST BE SUBMITTED ALONG WITH THIS MULLION PRODUCT APPROVAL.
- ANCHORING OF EACH GLAZING PRODUCT TO THE MULLION SHALL BE AS SHOWN IN EACH INDIVIDUAL GLAZING PRODUCT APPROVAL.
- SITE CONDITIONS NOT COVERED IN THIS EVALUATION ARE SUBJECT TO SEPARATE ENGINEERING EVALUATION.
- MULLION DESIGN PRESSURE RATING, SEE LOAD RATING TABLES OF THIS DRAWING.
- THE DESIGN PRESSURE RATING OF THE ASSEMBLY SHALL BE THE LESSER OF THE LOAD CAPACITY OF THE MULLION AS DETERMINED USING THIS APPROVAL OR THE DESIGN PRESSURE RATING OF THE INDIVIDUAL GLAZING PRODUCTS USED.
- BOUNDING BOX DIMENSIONS FOR GEOMETRIC SHAPES MUST BE EQUAL TO OR LESS THAN THE RECTANGULAR DIMENSIONS SHOWN HEREIN.
- IN AREAS REQUIRING WIND BORNE DEBRIS PROTECTION, WIND ZONE 4 AS DEFINED IN ASTM E1996 IS EXCLUDED UNLESS THE ASSEMBLY IS PROTECTED WITH AN IMPACT RESISTANT COVERING THAT COMPLIES WITH SECITON 1609.1.2 OF THE FBC.

### SUPPORTING DOCUMENTS & EVIDENCE

- THIS PRODUCT HAS BEEN ENGINEERED FOLLOWING ACCEPTED ENGINEERING PRACTICE CONFORMING TO THE REQUIREMENTS OF SECTION 1714.5.5 OF THE FLORIDA BUILDING CODE 2007 EDITION.

TABLE OF CONTENTS	
SHEET #	DESCRIPTION
1	TYPICAL ELEVATIONS & GENERAL NOTES
2	MULLION LOAD TABLE: CONCRETE SCREW ANCHORS CLIP B-4
3	MULLION LOAD TABLE: WOOD SCREW ANCHORS CLIP B-4
4	MULLION LOAD TABLE: CONCRETE SCREW ANCHORS CLIP B-1
5	MULLION LOAD TABLE: WOOD SCREW ANCHORS CLIP B-1
6	MULLION LOAD TABLE: WOOD OR CONCRETE SCREW ANCHOR PLATE
7	ANCHOR CLIP B-4: ANCHORING DETAILS
8	ANCHOR CLIP B-1: ANCHORING DETAILS
9	MULLION ANCHOR PLATE: ANCHORING DETAILS

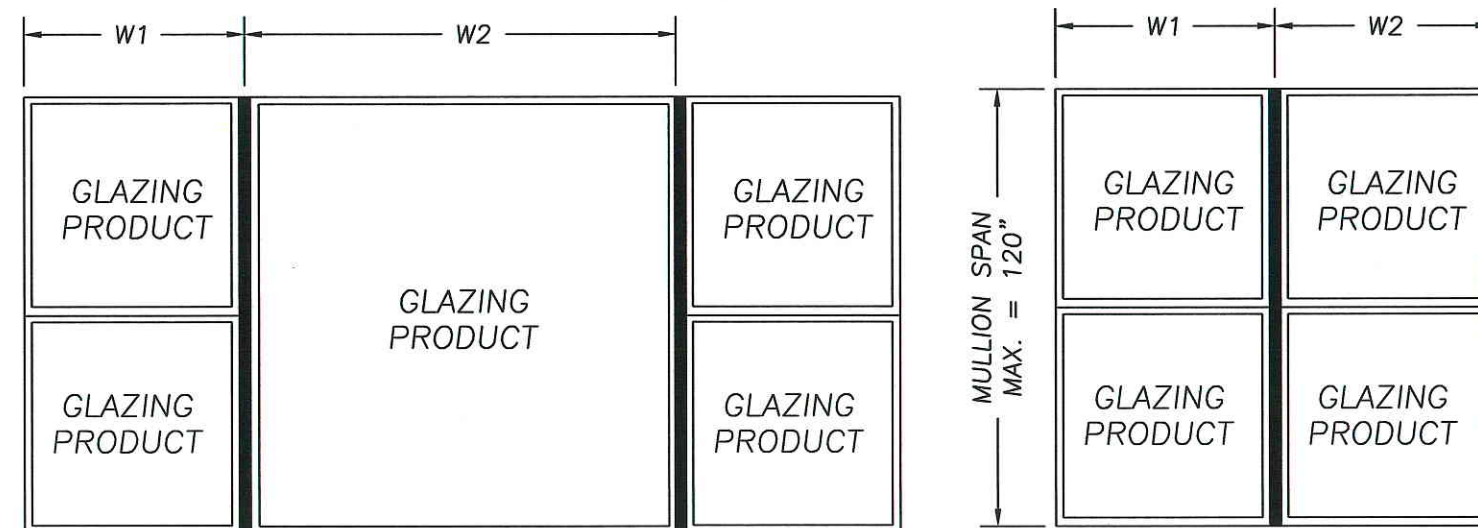
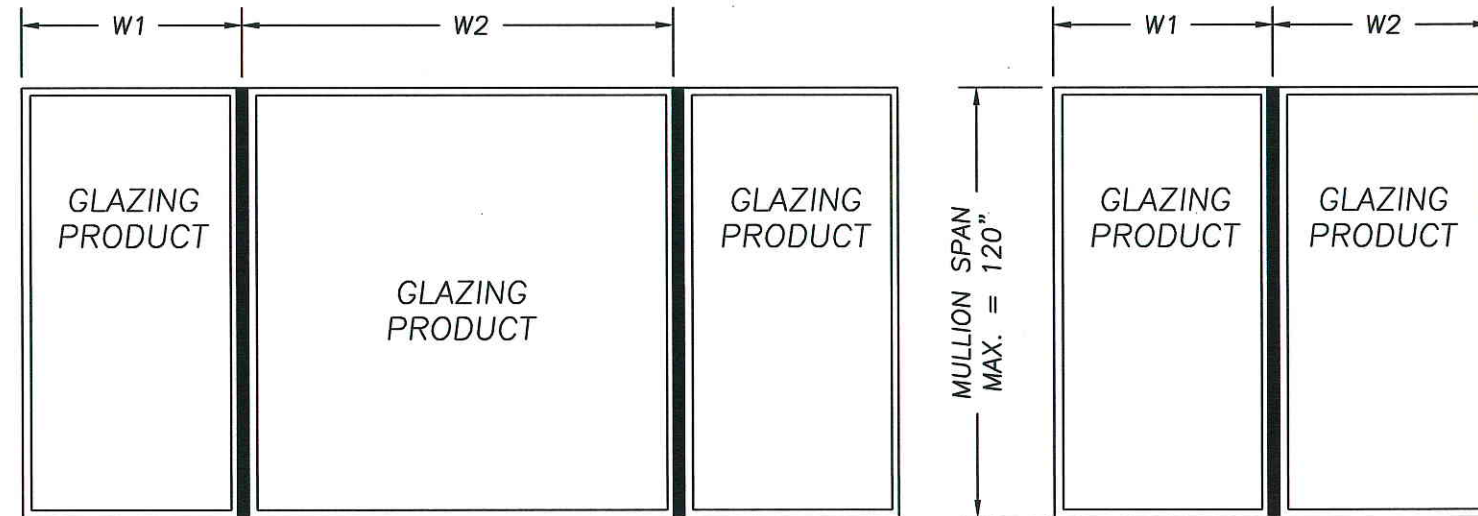

### TYPICAL MULLION CONFIGURATIONS

Documents Prepared By:

**RW** BUILDING CONSULTANTS, INC.  
P.O. Box 230 Vairico FL. 33595  
Phone No.: 813.659.9197

Florida Board of Professional Engineers  
Certificate Of Authorization/No. 9813

Wendell W. Haney, P.E. No. 54158

PRODUCT:

STRUCTURAL MULLION

PART OR ASSEMBLY:  
TYPICAL ELEVATIONS &  
GENERAL NOTES

NO.	DATE	WH	BY
1	9-9-08	REV. TO 2007 FBC	
REVISIONS			

DATE: 12/04/07

SCALE: NTS

DWG. BY: YV

CHK. BY: WWH

DRAWING NO.:

FL-8566.5

SHEET 1 OF 9

R:\A - Projects\Project Folders\Proj 1301-1400\PF 1324\DWG Drawings\FL-8566 R1\FL-8566.5\FL-8566.5-2.dwg, Model

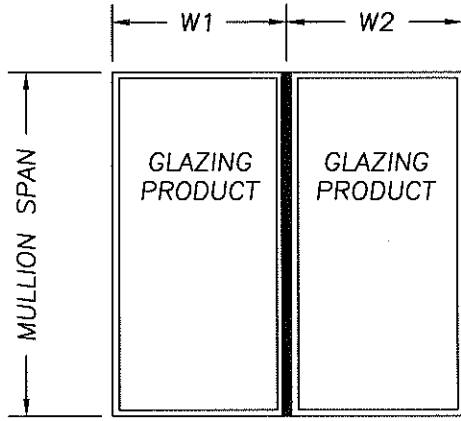

$$\text{TRIBUTARY WIDTH} = \frac{W1 + W2}{2}$$

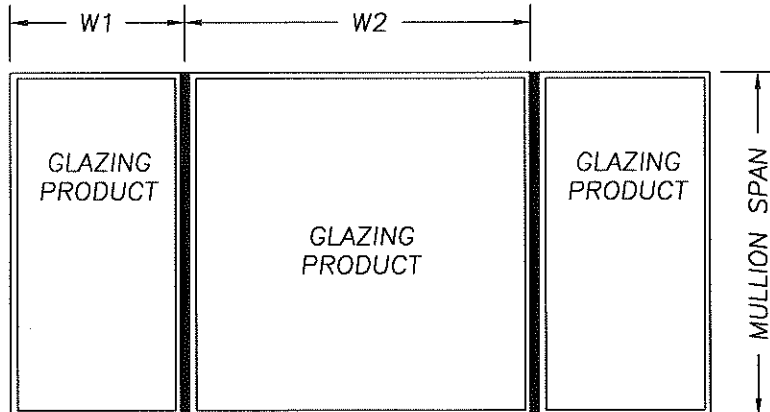

CONCRETE SCREW	2" x 3.5" LVL STRUCTURAL BEAM MULLION LOAD TABLE (PSF) - ANCHOR CLIP B4													
	TRIBUTARY WIDTH													
	24.0"	28.0"	30.0"	32.0"	34.0"	36.0"	38.0"	40.0"	42.0"	44.0"	46.0"	48.0"	50.0"	
120.0"	15.37	NA	NA	NA	NA	NA	NA	NA	NA	NA	NA	NA	NA	
116.0"	17.05	NA	NA	NA	NA	NA	NA	NA	NA	NA	NA	NA	NA	
112.0"	18.98	16.44	15.42	NA	NA	NA	NA	NA	NA	NA	NA	NA	NA	
108.0"	21.22	18.38	17.25	16.26	15.39	NA	NA	NA	NA	NA	NA	NA	NA	
104.0"	23.82	20.65	19.38	18.27	17.30	16.43	15.66	NA	NA	NA	NA	NA	NA	
100.0"	26.87	23.30	21.88	20.63	19.53	18.56	17.69	16.91	16.20	15.56	NA	NA	NA	
96.0"	30.45	26.43	24.82	23.41	22.17	21.07	20.09	19.21	18.41	17.69	17.03	16.43	15.87	
92.0"	34.71	30.14	28.31	26.72	25.31	24.06	22.95	21.95	21.04	20.23	19.48	18.79	18.15	
88.0"	39.80	34.58	32.50	30.67	29.07	27.65	26.38	25.23	24.20	23.27	22.41	21.61	20.87	
84.0"	45.94	39.94	37.55	35.45	33.61	31.98	30.52	29.21	28.03	26.95	25.95	25.02	24.15	
80.0"	53.41	46.47	43.70	41.28	39.15	37.27	35.58	34.07	32.69	31.42	30.25	29.16	28.14	
76.0"	62.59	54.50	51.28	48.46	45.98	43.79	41.83	40.05	38.42	36.92	35.53	34.24	33.04	
72.0"	73.99	64.50	60.71	57.41	54.50	51.93	49.60	47.48	45.53	43.74	42.08	40.54	39.12	
68.0"	80.79	71.81	68.29	65.25	62.62	60.25	58.06	56.02	54.13	52.31	50.31	48.46	46.74	
64.0"	87.00	77.55	73.86	70.69	67.86	65.25	62.83	60.59	58.50	56.55	54.73	53.02	51.41	
60.0"	94.25	84.30	80.43	77.00	73.86	70.96	68.29	65.80	63.49	61.34	59.33	57.45	55.68	
56.0"	102.82	92.33	88.13	84.30	80.79	77.55	74.57	71.81	69.24	66.86	64.63	62.54	60.59	
52.0"	113.10	101.85	97.12	92.80	88.85	85.22	81.88	78.79	75.93	73.26	70.78	68.46	66.29	
48.0"	125.67	113.10	107.71	102.82	98.35	94.25	90.48	87.00	83.78	80.79	78.00	75.40	72.97	
44.0"	141.01	126.55	120.37	114.77	109.67	105.01	100.72	96.77	93.12	89.73	86.58	83.65	80.91	
40.0"	150.00	142.86	135.72	129.26	123.38	118.02	113.10	108.58	104.40	100.53	96.94	93.60	90.48	
36.0"	150.00	150.00	150.00	147.12	140.28	134.04	128.34	123.10	118.27	113.81	109.67	105.82	102.24	
32.0"	150.00	150.00	150.00	150.00	150.00	150.00	147.52	141.38	135.72	130.50	125.67	121.18	117.00	
28.0"	150.00	150.00	150.00	150.00	150.00	150.00	150.00	150.00	150.00	150.00	146.33	141.01	136.06	
24.0"	150.00	150.00	150.00	150.00	150.00	150.00	150.00	150.00	150.00	150.00	150.00	150.00	150.00	
20.0"	150.00	150.00	150.00	150.00	150.00	150.00	150.00	150.00	150.00	150.00	150.00	150.00	150.00	

**INSTRUCTIONS FOR USE OF THE MULLION LOAD TABLE:**

1. DETERMINE THE DESIGN LOAD REQUIREMENT PER CHAPTER 16 OF THE FBC FOR THE PARTICULAR OPENING.
2. FOR THE PARTICULAR OPENING, DETERMINE THE TRIBUTARY WIDTH AND MULLION SPAN. REFERENCE THE SKETCHES ON THIS SHEET FOR MULLION SPAN AND TRIBUTARY WIDTH DETERMINATION.
3. IN THE FIRST COLUMN OF THE TABLE, LOCATE THE MULLION SPAN. IN THE FIRST ROW OF THE TABLE, LOCATE THE TRIBUTARY WIDTH. AT THE INTERSECTION OF THE ROW CONTAINING THE MULLION SPAN AND THE COLUMN CONTAINING THE TRIBUTARY WIDTH, READ THE MULLION LOAD RATING GIVEN IN PSF. THE MULLION LOAD RATING MUST BE EQUAL TO OR GREATER THAN THE DESIGN LOAD REQUIREMENT DETERMINED IN STEP 1 ABOVE.

Documents Prepared By: **RW** BUILDING CONSULTANTS, INC.  
P.O. Box 230 Valrico FL, 33595  
Phone No.: 813.659.9197  
Florida Board of Professional Engineers  
Certificate Of Authorization No. 9813  
Wendell W. Hapey, P.E. No. 54158

PRODUCT: STRUCTURAL MULLION

PART OR ASSEMBLY: MULLION LOAD TABLE: TAPCON SCREW ANCHORS

NO.	DATE	REV.	BY
1	9-9-08	REV. TO 2007 FBC	WH

REVISIONS

DATE: 12/04/07  
SCALE: NTS  
DWG. BY: YV  
CHK. BY: WWH  
DRAWING NO.: FL-8566.5  
SHEET 2 OF 9

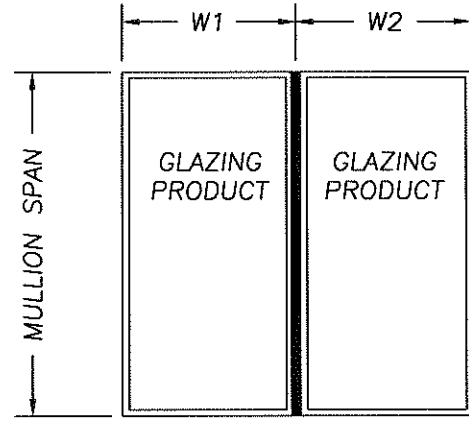

$$\text{TRIBUTARY WIDTH} = \frac{W1 + W2}{2}$$

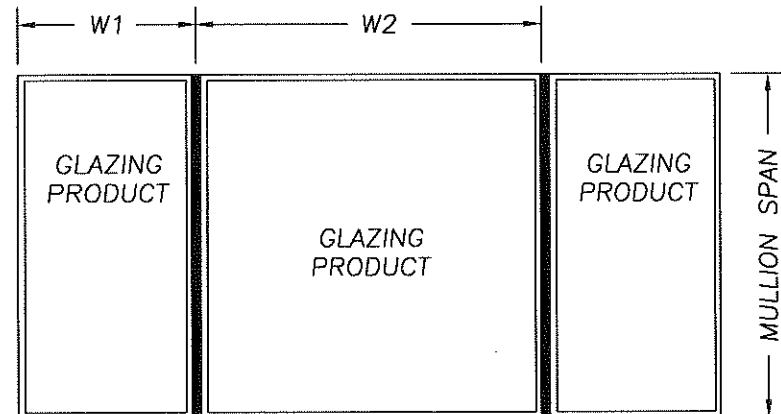

### 2" x 3.5" LVL STRUCTURAL BEAM MULLION LOAD TABLE (PSF) - ANCHOR CLIP B4

WOOD SCREW	TRIBUTARY WIDTH													
	24.0"	28.0"	32.0"	32.0"	34.0"	36.0"	38.0"	40.0"	42.0"	44.0"	46.0"	48.0"	50.0"	
MULLION SPAN	120.0"	15.37	NA	NA	NA	NA	NA	NA	NA	NA	NA	NA	NA	NA
	116.0"	17.05	NA	NA	NA	NA	NA	NA	NA	NA	NA	NA	NA	NA
	112.0"	18.98	16.44	NA	NA	NA	NA	NA	NA	NA	NA	NA	NA	NA
	108.0"	21.22	18.38	16.26	16.26	15.39	NA	NA	NA	NA	NA	NA	NA	NA
	104.0"	23.82	20.65	18.27	18.27	17.30	16.43	15.66	NA	NA	NA	NA	NA	NA
	100.0"	26.87	23.30	20.63	20.63	19.53	18.56	17.69	16.91	16.20	15.56	NA	NA	NA
	96.0"	30.45	26.43	23.41	23.41	22.17	21.07	20.09	19.21	18.41	17.69	17.03	16.43	15.87
	92.0"	34.71	30.14	26.72	26.72	25.31	24.06	22.95	21.95	21.04	20.23	19.48	18.79	18.15
	88.0"	39.80	34.58	30.67	30.67	29.07	27.65	26.38	25.23	24.20	23.27	22.41	21.61	20.87
	84.0"	45.94	39.94	35.45	35.45	33.61	31.98	30.52	29.21	28.03	26.95	25.95	25.02	24.15
	80.0"	53.41	46.47	41.28	41.28	39.15	37.27	35.58	34.07	32.69	31.42	30.25	29.16	28.14
	76.0"	62.59	54.50	48.46	48.46	45.98	43.79	41.83	40.05	38.42	36.92	35.53	34.24	33.04
	72.0"	73.99	64.50	57.41	57.41	54.50	51.93	49.60	47.48	45.53	43.74	42.08	40.54	39.12
	68.0"	80.79	71.81	65.25	65.25	62.62	60.25	58.06	56.02	54.13	52.31	50.31	48.46	46.74
	64.0"	87.00	77.55	70.69	70.69	67.86	65.25	62.83	60.59	58.50	56.55	54.73	53.02	51.41
	60.0"	94.25	84.30	77.00	77.00	73.86	70.96	68.29	65.80	63.49	61.34	59.33	57.45	55.68
	56.0"	102.82	92.33	84.30	84.30	80.79	77.55	74.57	71.81	69.24	66.86	64.63	62.54	60.59
	52.0"	113.10	101.85	92.80	92.80	88.85	85.22	81.88	78.79	75.93	73.26	70.78	68.46	66.29
	48.0"	125.67	113.10	102.82	102.82	98.35	94.25	90.48	87.00	83.78	80.79	78.00	75.40	72.97
	44.0"	141.01	126.55	114.77	114.77	109.67	105.01	100.72	96.77	93.12	89.73	86.58	83.65	80.91
	40.0"	150.00	142.86	129.26	129.26	123.38	118.02	113.10	108.58	104.40	100.53	96.94	93.60	90.48
	36.0"	150.00	150.00	147.12	147.12	140.28	134.04	128.34	123.10	118.27	113.81	109.67	105.82	102.24
	32.0"	150.00	150.00	150.00	150.00	150.00	150.00	147.52	141.38	135.72	130.50	125.67	121.18	117.00
	28.0"	150.00	150.00	150.00	150.00	150.00	150.00	150.00	150.00	150.00	150.00	146.33	141.01	136.06
	24.0"	150.00	150.00	150.00	150.00	150.00	150.00	150.00	150.00	150.00	150.00	150.00	150.00	150.00
	20.0"	150.00	150.00	150.00	150.00	150.00	150.00	150.00	150.00	150.00	150.00	150.00	150.00	150.00

**INSTRUCTIONS FOR USE OF THE MULLION LOAD TABLE:**

1. DETERMINE THE DESIGN LOAD REQUIREMENT PER CHAPTER 16 OF THE FBC FOR THE PARTICULAR OPENING.
2. FOR THE PARTICULAR OPENING, DETERMINE THE TRIBUTARY WIDTH AND MULLION SPAN. REFERENCE THE SKETCHES ON THIS SHEET FOR MULLION SPAN AND TRIBUTARY WIDTH DETERMINATION.
3. IN THE FIRST COLUMN OF THE TABLE, LOCATE THE MULLION SPAN. IN THE FIRST ROW OF THE TABLE, LOCATE THE TRIBUTARY WIDTH. AT THE INTERSECTION OF THE ROW CONTAINING THE MULLION SPAN AND THE COLUMN CONTAINING THE TRIBUTARY WIDTH, READ THE MULLION LOAD RATING GIVEN IN PSF. THE MULLION LOAD RATING MUST BE EQUAL TO OR GREATER THAN THE DESIGN LOAD REQUIREMENT DETERMINED IN STEP 1 ABOVE.

Documents Prepared By: **RW** BUILDING CONSULTANTS, INC.  
P.O. Box 230 Valrico FL 33595  
Phone No.: 813.659.9197  
Florida Board of Professional Engineers  
Certificate Of Authorization No. 9813  
Wendell W. Haney, P.E. 54158

DATE: 12/04/07  
SCALE: NTS  
DWG. BY: YV  
CHK. BY: WWH  
DRAWING NO.: FL-8566.5  
SHEET 3 OF 9

PRODUCT: STRUCTURAL MULLION  
PART OR ASSEMBLY: MULLION PLATE TABLE: WOOD SCREW ANCHORS

NO.	DATE	WH	BY
1	9-9-08	REV. TO 2007 FBC	

REVISIONS

R:\A - Projects\Project Folders\Proj 1301-1400\PF 1324\D. RWBC Drawings\FL-8566 R1\FL-8566.5\FL-8566.5-4.dwg, Model

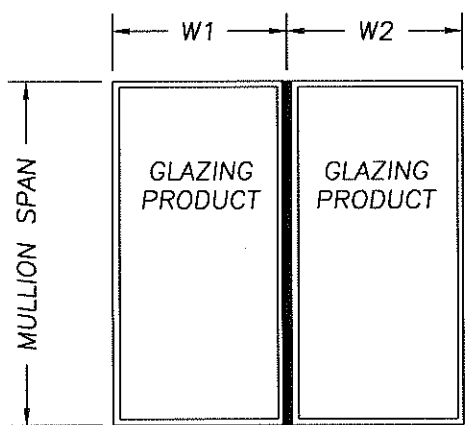

$$\text{TRIBUTARY WIDTH} = \frac{W1 + W2}{2}$$

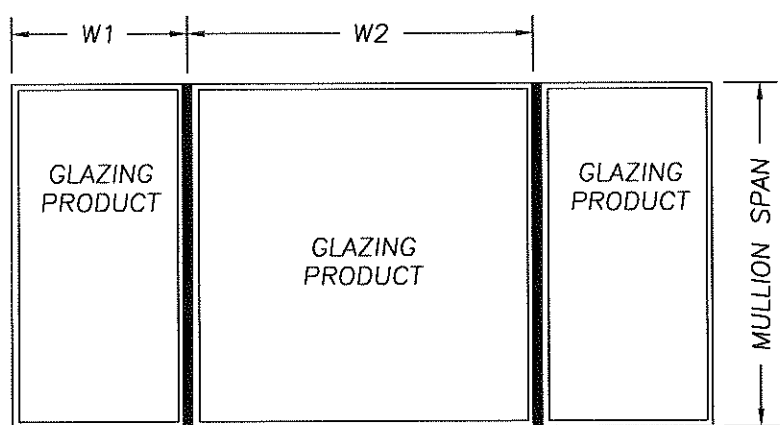

		2" x 3.5" LVL STRUCTURAL BEAM MULLION LOAD TABLE (PSF) - ANCHOR CLIP B1												
CONCRETE SCREW	MULLION SPAN	TRIBUTARY WIDTH												
		24.0"	28.0"	30.0"	32.0"	34.0"	36.0"	38.0"	40.0"	42.0"	44.0"	46.0"	48.0"	50.0"
120.0"		15.37	NA	NA	NA	NA	NA	NA	NA	NA	NA	NA	NA	NA
116.0"		17.05	NA	NA	NA	NA	NA	NA	NA	NA	NA	NA	NA	NA
112.0"		18.98	16.44	15.42	NA	NA	NA	NA	NA	NA	NA	NA	NA	NA
108.0"		21.22	18.38	17.25	16.26	15.39	NA	NA	NA	NA	NA	NA	NA	NA
104.0"		23.82	20.65	19.38	18.27	17.30	16.43	15.66	NA	NA	NA	NA	NA	NA
100.0"		26.87	23.30	21.88	20.63	19.53	18.56	17.69	16.91	16.20	15.56	NA	NA	NA
96.0"		30.45	26.43	24.82	23.41	22.17	21.07	20.09	19.21	18.41	17.69	17.03	16.43	15.87
92.0"		34.71	30.14	28.31	26.72	25.31	24.06	22.95	21.95	21.04	20.23	19.48	18.79	18.15
88.0"		39.80	34.58	32.50	30.67	29.07	27.65	26.38	25.23	24.20	23.27	22.41	21.61	20.87
84.0"		45.94	39.94	37.55	35.45	33.61	31.98	30.52	29.21	28.03	26.95	25.95	25.02	24.15
80.0"		53.41	46.47	43.70	41.28	39.15	37.27	35.58	34.07	32.69	31.42	30.25	29.16	28.14
76.0"		62.59	54.50	51.28	48.46	45.98	43.79	41.83	40.05	38.42	36.92	35.53	34.24	33.04
72.0"		73.99	64.50	60.71	57.41	54.50	51.93	49.60	47.48	45.53	43.74	42.08	40.54	39.12
68.0"		88.35	77.10	72.62	68.71	65.26	62.18	59.38	56.82	54.47	52.31	50.31	48.46	46.74
64.0"		106.69	93.22	87.85	83.17	79.02	75.25	71.83	68.71	65.85	63.21	60.78	58.53	56.44
60.0"		130.47	114.16	107.67	101.95	96.80	92.15	87.93	84.07	80.54	77.30	74.30	71.53	68.96
56.0"		150.00	140.82	133.84	126.66	120.20	114.37	109.09	104.26	99.85	95.80	92.06	88.60	85.39
52.0"		150.00	150.00	148.12	141.54	135.52	129.98	124.89	120.17	115.80	111.74	107.95	104.41	101.10
48.0"		150.00	150.00	150.00	150.00	150.00	150.00	143.75	138.00	132.69	127.78	123.21	118.97	115.00
44.0"		150.00	150.00	150.00	150.00	150.00	150.00	150.00	150.00	147.59	142.02	136.86	132.06	127.58
40.0"		150.00	150.00	150.00	150.00	150.00	150.00	150.00	150.00	150.00	150.00	150.00	147.86	142.76
36.0"		150.00	150.00	150.00	150.00	150.00	150.00	150.00	150.00	150.00	150.00	150.00	150.00	150.00
32.0"		150.00	150.00	150.00	150.00	150.00	150.00	150.00	150.00	150.00	150.00	150.00	150.00	150.00
28.0"		150.00	150.00	150.00	150.00	150.00	150.00	150.00	150.00	150.00	150.00	150.00	150.00	150.00
24.0"		150.00	150.00	150.00	150.00	150.00	150.00	150.00	150.00	150.00	150.00	150.00	150.00	150.00
20.0"		150.00	150.00	150.00	150.00	150.00	150.00	150.00	150.00	150.00	150.00	150.00	150.00	150.00

**INSTRUCTIONS FOR USE OF THE MULLION LOAD TABLE:**

1. DETERMINE THE DESIGN LOAD REQUIREMENT PER CHAPTER 16 OF THE FBC FOR THE PARTICULAR OPENING.
2. FOR THE PARTICULAR OPENING, DETERMINE THE TRIBUTARY WIDTH AND MULLION SPAN. REFERENCE THE SKETCHES ON THIS SHEET FOR MULLION SPAN AND TRIBUTARY WIDTH DETERMINATION.
3. IN THE FIRST COLUMN OF THE TABLE, LOCATE THE MULLION SPAN. IN THE FIRST ROW OF THE TABLE, LOCATE THE TRIBUTARY WIDTH. AT THE INTERSECTION OF THE ROW CONTAINING THE MULLION SPAN AND THE COLUMN CONTAINING THE TRIBUTARY WIDTH, READ THE MULLION LOAD RATING GIVEN IN PSF. THE MULLION LOAD RATING MUST BE EQUAL TO OR GREATER THAN THE DESIGN LOAD REQUIREMENT DETERMINED IN STEP 1 ABOVE.

Documents Prepared By: **RW BUILDING CONSULTANTS, INC.**  
P.O. Box 230 Valrico FL 33595  
Phone No.: 813.659.9197  
Florida Board of Professional Engineers  
Certificate Of Authorization No. 9813  
*Wendell W. Haney* 9/9/08  
Wendell W. Haney, P.E. No. 54158

---

PRODUCT: STRUCTURAL MULLION  
PART OR ASSEMBLY: MULLION LOAD TABLE: TAPCON SCREW ANCHORS

NO.	DATE	REV.	WH	BY
1	9-9-08	REV. TO 2007 FBC		

REVISIONS

---

DATE: 12/04/07  
SCALE: NTS  
DWG. BY: YV  
CHK. BY: WWH  
DRAWING NO.: FL-8566.5  
SHEET 4 OF 9

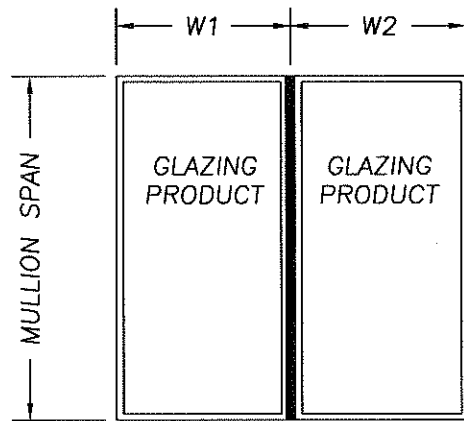

$$\text{TRIBUTARY WIDTH} = \frac{W1 + W2}{2}$$

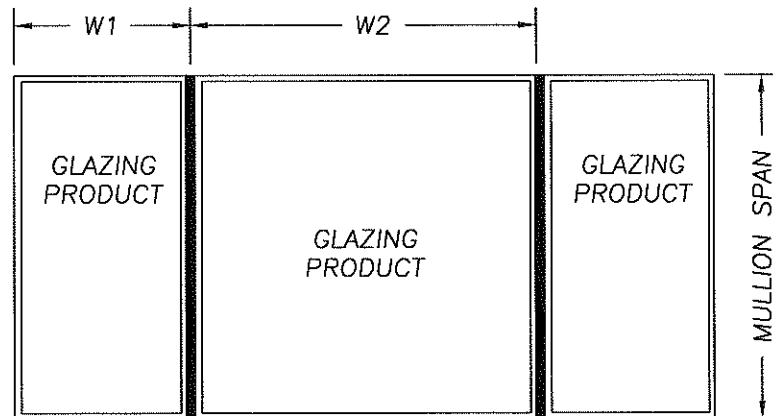

### 2" x 3.5" LVL STRUCTURAL BEAM MULLION LOAD TABLE (PSF) - ANCHOR CLIP B1

WOOD SCREW	TRIBUTARY WIDTH													
	24.0"	28.0"	30.0"	32.0"	34.0"	36.0"	38.0"	40.0"	42.0"	44.0"	46.0"	48.0"	50.0"	
MULLION SPAN 120.0"	15.37	NA	NA	NA	NA	NA	NA	NA	NA	NA	NA	NA	NA	
MULLION SPAN 116.0"	17.05	NA	NA	NA	NA	NA	NA	NA	NA	NA	NA	NA	NA	
MULLION SPAN 112.0"	18.98	16.44	15.42	NA	NA	NA	NA	NA	NA	NA	NA	NA	NA	
MULLION SPAN 108.0"	21.22	18.38	17.25	16.26	15.39	NA	NA	NA	NA	NA	NA	NA	NA	
MULLION SPAN 104.0"	23.82	20.65	19.38	18.27	17.30	16.43	15.66	NA	NA	NA	NA	NA	NA	
MULLION SPAN 100.0"	26.87	23.30	21.88	20.63	19.53	18.56	17.69	16.91	16.20	15.56	NA	NA	NA	
MULLION SPAN 96.0"	30.45	26.43	24.82	23.41	22.17	21.07	20.09	19.21	18.41	17.69	17.03	16.43	15.87	
MULLION SPAN 92.0"	34.71	30.14	28.31	26.72	25.31	24.06	22.95	21.95	21.04	20.23	19.48	18.79	18.15	
MULLION SPAN 88.0"	39.80	34.58	32.50	30.67	29.07	27.65	26.38	25.23	24.20	23.27	22.41	21.61	20.87	
MULLION SPAN 84.0"	45.94	39.94	37.55	35.45	33.61	31.98	30.52	29.21	28.03	26.95	25.95	25.02	24.15	
MULLION SPAN 80.0"	53.41	46.47	43.70	41.28	39.15	37.27	35.58	34.07	32.69	31.42	30.25	29.16	28.14	
MULLION SPAN 76.0"	62.59	54.50	51.28	48.46	45.98	43.79	41.83	40.05	38.42	36.92	35.53	34.24	33.04	
MULLION SPAN 72.0"	73.99	64.50	60.71	57.41	54.50	51.93	49.60	47.48	45.53	43.74	42.08	40.54	39.12	
MULLION SPAN 68.0"	88.35	77.10	72.62	68.71	65.26	62.18	59.38	56.82	54.47	52.31	50.31	48.46	46.74	
MULLION SPAN 64.0"	106.69	93.22	87.85	83.17	79.02	75.25	71.83	68.71	65.85	63.21	60.78	58.53	56.44	
MULLION SPAN 60.0"	130.47	114.16	107.67	101.95	96.80	92.15	87.93	84.07	80.54	77.30	74.30	71.53	68.96	
MULLION SPAN 56.0"	150.00	140.82	133.84	126.66	120.20	114.37	109.09	104.26	99.85	95.80	92.06	88.60	85.39	
MULLION SPAN 52.0"	150.00	150.00	148.12	141.54	135.52	129.98	124.89	120.17	115.80	111.74	107.95	104.41	101.10	
MULLION SPAN 48.0"	150.00	150.00	150.00	150.00	150.00	143.75	138.00	132.69	127.78	123.21	118.97	115.00	111.29	
MULLION SPAN 44.0"	150.00	150.00	150.00	150.00	150.00	150.00	150.00	147.59	142.02	136.86	132.06	127.58	123.40	
MULLION SPAN 40.0"	150.00	150.00	150.00	150.00	150.00	150.00	150.00	150.00	150.00	150.00	147.86	142.76	138.00	
MULLION SPAN 36.0"	150.00	150.00	150.00	150.00	150.00	150.00	150.00	150.00	150.00	150.00	150.00	150.00	150.00	
MULLION SPAN 32.0"	150.00	150.00	150.00	150.00	150.00	150.00	150.00	150.00	150.00	150.00	150.00	150.00	150.00	
MULLION SPAN 28.0"	150.00	150.00	150.00	150.00	150.00	150.00	150.00	150.00	150.00	150.00	150.00	150.00	150.00	
MULLION SPAN 24.0"	150.00	150.00	150.00	150.00	150.00	150.00	150.00	150.00	150.00	150.00	150.00	150.00	150.00	
MULLION SPAN 20.0"	150.00	150.00	150.00	150.00	150.00	150.00	150.00	150.00	150.00	150.00	150.00	150.00	150.00	

**INSTRUCTIONS FOR USE OF THE MULLION LOAD TABLE:**

1. DETERMINE THE DESIGN LOAD REQUIREMENT PER CHAPTER 16 OF THE FBC FOR THE PARTICULAR OPENING.
2. FOR THE PARTICULAR OPENING, DETERMINE THE TRIBUTARY WIDTH AND MULLION SPAN. REFERENCE THE SKETCHES ON THIS SHEET FOR MULLION SPAN AND TRIBUTARY WIDTH DETERMINATION.
3. IN THE FIRST COLUMN OF THE TABLE, LOCATE THE MULLION SPAN. IN THE FIRST ROW OF THE TABLE, LOCATE THE TRIBUTARY WIDTH. AT THE INTERSECTION OF THE ROW CONTAINING THE MULLION SPAN AND THE COLUMN CONTAINING THE TRIBUTARY WIDTH, READ THE MULLION LOAD RATING GIVEN IN PSF. THE MULLION LOAD RATING MUST BE EQUAL TO OR GREATER THAN THE DESIGN LOAD REQUIREMENT DETERMINED IN STEP 1 ABOVE.

Documents Prepared By: **RW** BUILDING CONSULTANTS, INC.  
P.O. Box 230 Valrico FL 33595  
Phone No.: 813.659.9197  
Florida Board of Professional Engineers  
Certificate Of Authorization No. 9813  
Wendell W. Hoppey, P.E. No. 54158

DATE: 12/04/07  
SCALE: NTS  
DWG. BY: YV  
CHK. BY: WWH  
DRAWING NO.: FL-8566.5  
SHEET 5 OF 9

PRODUCT: STRUCTURAL MULLION  
PART OR ASSEMBLY: MULLION LOAD TABLE: WOOD SCREW ANCHORS

NO.	DATE	REV.	BY	WH
1	9-9-08	REV. TO 2007 FBC		

REVISIONS

R:\A - Projects\Project Folders\Proj 1301-1400\PF 1324\D. RWBC Drawings\FL-8566 R1\FL-8566.5\FL-8566.5-6.dwg, Model

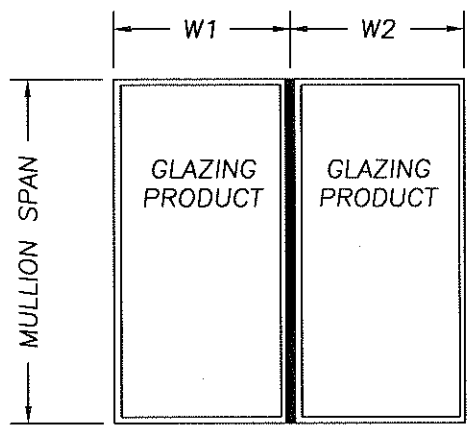

$$\text{TRIBUTARY WIDTH} = \frac{W1 + W2}{2}$$

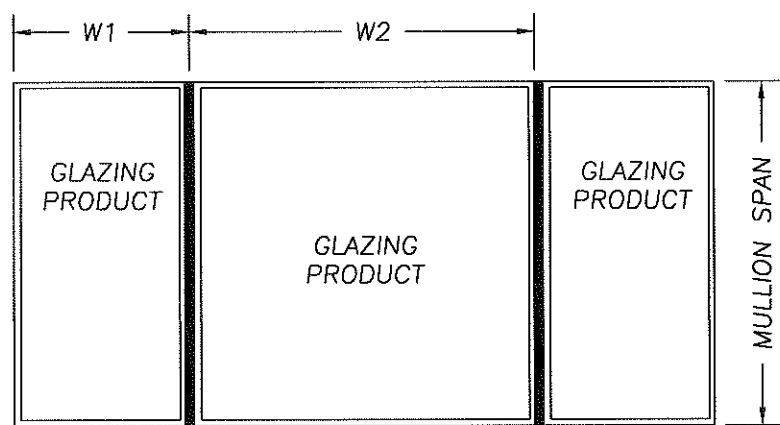

WOOD OR CONCRETE SCREW	2" x 3.5" LVL STRUCTURAL BEAM MULLION LOAD TABLE (PSF) - ANCHOR PLATE													
	TRIBUTARY WIDTH													
	24.0"	28.0"	30.0"	32.0"	34.0"	36.0"	38.0"	40.0"	42.0"	44.0"	46.0"	48.0"	50.0"	
120.0"	15.37	NA	NA	NA	NA	NA	NA	NA	NA	NA	NA	NA	NA	
116.0"	17.05	NA	NA	NA	NA	NA	NA	NA	NA	NA	NA	NA	NA	
112.0"	18.98	16.44	15.42	NA	NA	NA	NA	NA	NA	NA	NA	NA	NA	
108.0"	21.22	18.38	17.25	16.26	15.39	NA	NA	NA	NA	NA	NA	NA	NA	
104.0"	23.82	20.65	19.38	18.27	17.30	16.43	15.66	NA	NA	NA	NA	NA	NA	
100.0"	26.87	23.30	21.88	20.63	19.53	18.56	17.69	16.91	16.20	15.56	NA	NA	NA	
96.0"	30.45	26.43	24.82	23.41	22.17	21.07	20.09	19.21	18.41	17.69	17.03	16.43	15.87	
92.0"	34.20	30.07	28.31	26.72	25.31	24.06	22.95	21.95	21.04	20.23	19.48	18.79	18.15	
88.0"	36.00	31.69	29.98	28.50	27.20	26.06	25.04	24.14	23.33	22.61	21.95	21.32	20.73	
84.0"	38.00	33.50	31.72	30.18	28.83	27.64	26.58	25.65	24.82	24.05	23.33	22.66	22.02	
80.0"	40.24	35.53	33.67	32.06	30.66	29.42	28.33	27.36	26.48	25.65	24.87	24.14	23.45	
76.0"	42.75	37.82	35.88	34.20	32.73	31.45	30.32	29.29	28.33	27.43	26.58	25.79	25.04	
72.0"	45.60	40.43	38.40	36.64	35.11	33.78	32.57	31.45	30.40	29.42	28.50	27.64	26.82	
68.0"	48.86	43.43	41.30	39.46	37.87	36.44	35.11	33.88	32.73	31.66	30.66	29.71	28.83	
64.0"	52.62	46.90	44.67	42.75	41.04	39.46	38.00	36.64	35.38	34.20	33.10	32.06	31.09	
60.0"	57.00	50.98	48.64	46.57	44.67	42.92	41.30	39.80	38.40	37.10	35.88	34.74	33.67	
56.0"	62.18	55.84	53.30	50.98	48.86	46.90	45.10	43.43	41.88	40.43	39.09	37.82	36.64	
52.0"	68.40	61.60	58.73	56.12	53.73	51.54	49.52	47.65	45.92	44.31	42.81	41.40	40.09	
48.0"	76.00	68.40	65.14	62.18	59.48	57.00	54.72	52.62	50.67	48.86	47.17	45.60	44.13	
44.0"	85.28	76.53	72.80	69.41	66.33	63.50	60.91	58.52	56.32	54.27	52.36	50.59	48.93	
40.0"	96.56	86.40	82.08	78.17	74.62	71.37	68.40	65.66	63.14	60.80	58.63	56.61	54.72	
36.0"	110.55	98.59	93.54	88.98	84.84	81.07	77.62	74.45	71.53	68.83	66.33	64.00	61.83	
32.0"	128.25	114.00	108.00	102.60	97.71	93.27	89.22	85.50	82.08	78.92	76.00	73.29	70.76	
28.0"	150.00	134.01	126.76	120.26	114.40	109.08	104.23	99.79	95.72	91.97	88.50	85.28	82.29	
24.0"	150.00	150.00	150.00	144.00	136.80	130.29	124.36	118.96	114.00	109.44	105.23	101.33	97.71	
20.0"	150.00	150.00	150.00	150.00	150.00	150.00	150.00	145.92	139.71	134.01	128.75	123.89	119.39	

**INSTRUCTIONS FOR USE OF THE MULLION LOAD TABLE:**

1. DETERMINE THE DESIGN LOAD REQUIREMENT PER CHAPTER 16 OF THE FBC FOR THE PARTICULAR OPENING.
2. FOR THE PARTICULAR OPENING, DETERMINE THE TRIBUTARY WIDTH AND MULLION SPAN. REFERENCE THE SKETCHES ON THIS SHEET FOR MULLION SPAN AND TRIBUTARY WIDTH DETERMINATION.
3. IN THE FIRST COLUMN OF THE TABLE, LOCATE THE MULLION SPAN. IN THE FIRST ROW OF THE TABLE, LOCATE THE TRIBUTARY WIDTH. AT THE INTERSECTION OF THE ROW CONTAINING THE MULLION SPAN AND THE COLUMN CONTAINING THE TRIBUTARY WIDTH, READ THE MULLION LOAD RATING GIVEN IN PSF. THE MULLION LOAD RATING MUST BE EQUAL TO OR GREATER THAN THE DESIGN LOAD REQUIREMENT DETERMINED IN STEP 1 ABOVE.

Documents Prepared By: **RW** BUILDING CONSULTANTS, INC.  
P.O. Box 230 Vairico FL 33595  
Phone No.: 813.659.9197

Florida Board of Professional Engineers  
Certificate Of Authorization No. 9813  
Wendell W. Hapey, P.E. No. 54158

DATE: 12/04/07

SCALE: NTS

DWG. BY: YV

CHK. BY: WWH

DRAWING NO.: FL-8566.5

SHEET 6 OF 9

PRODUCT: STRUCTURAL MULLION

PART OR ASSEMBLY: MULLION LOAD TABLE: WOOD OR CONCRETE SCREW ANCHOR PLATE

NO.	DATE	REV.	WH	BY
1	9-9-08	REV. TO 2007 FBC		

REVISIONS

R:\A - Projects\Project Folders\Proj 1301-1400\PF 1324\ID. RWBC Drawings\FL-8566 R\FL-8566.5\FL-8566.5-7.dwg, Model

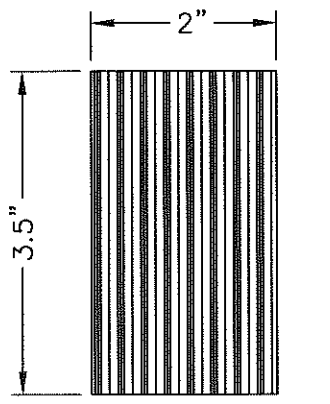

2" x 3.5" LVL MULLION

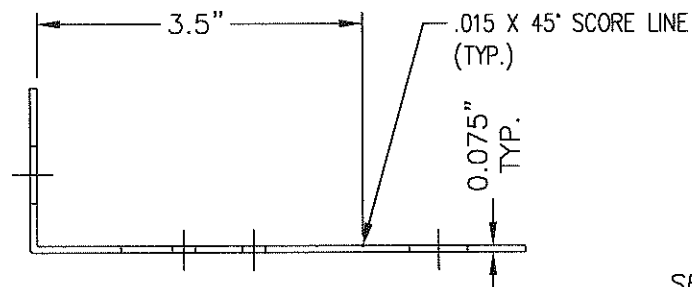
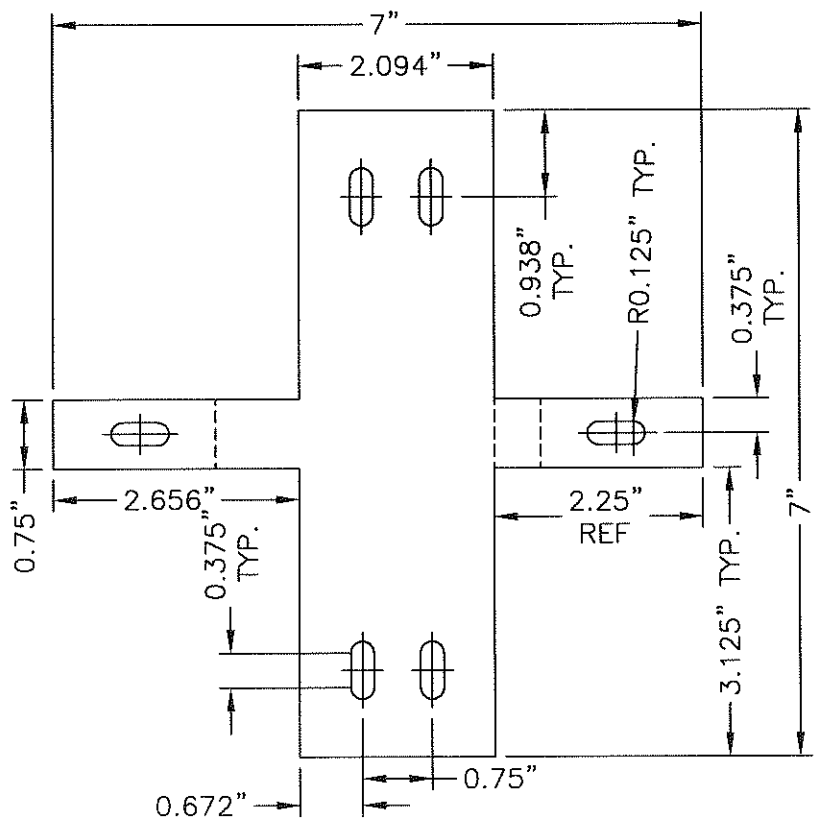

MULL CLIP - B4

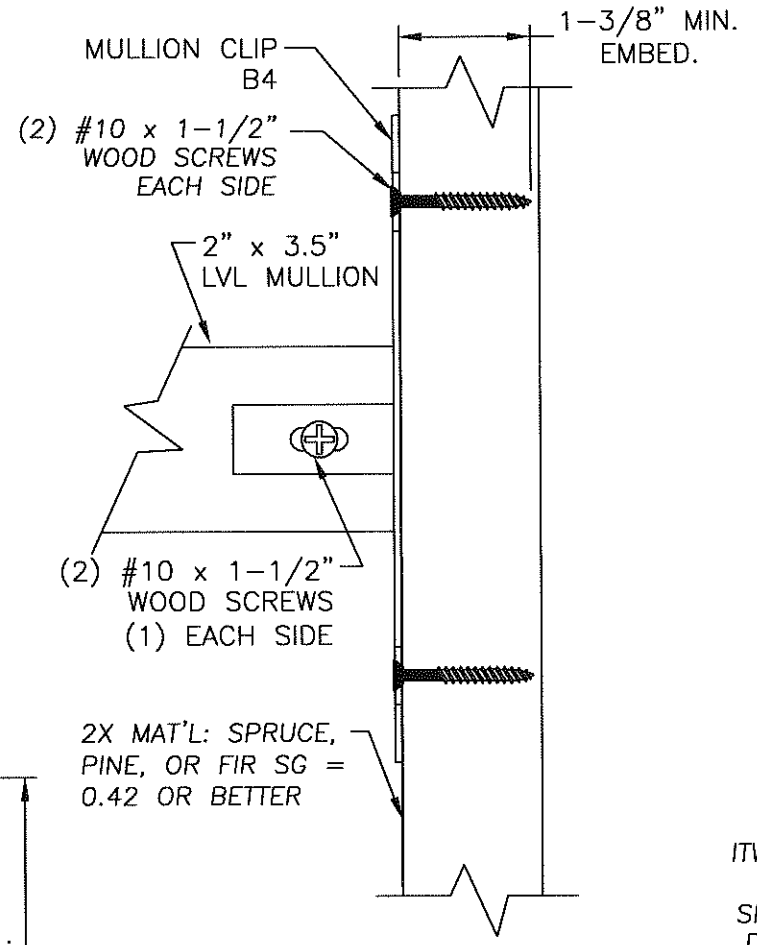

2X MAT'L: SPRUCE, PINE, OR FIR SG = 0.42 OR BETTER

ANCHOR TO 2X

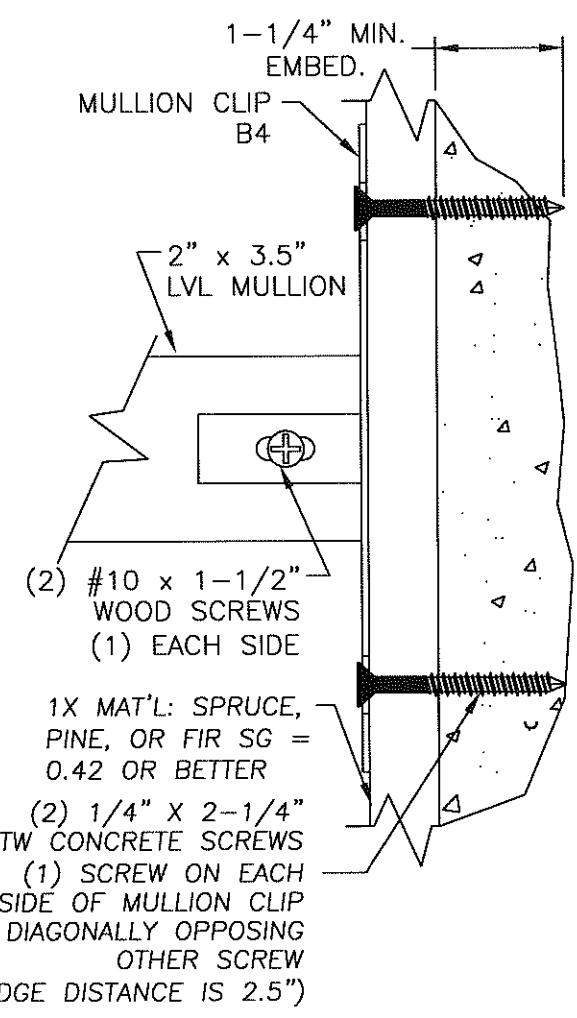

1X MAT'L: SPRUCE, PINE, OR FIR SG = 0.42 OR BETTER  
 (2) 1/4" X 2-1/4" ITW CONCRETE SCREWS  
 (1) SCREW ON EACH SIDE OF MULLION CLIP DIAGONALLY OPPOSING OTHER SCREW  
 (MIN. EDGE DISTANCE IS 2.5")

ANCHOR THROUGH 1X BUCK USING 1/4" X 2-1/4" ITW CONCRETE SCREWS

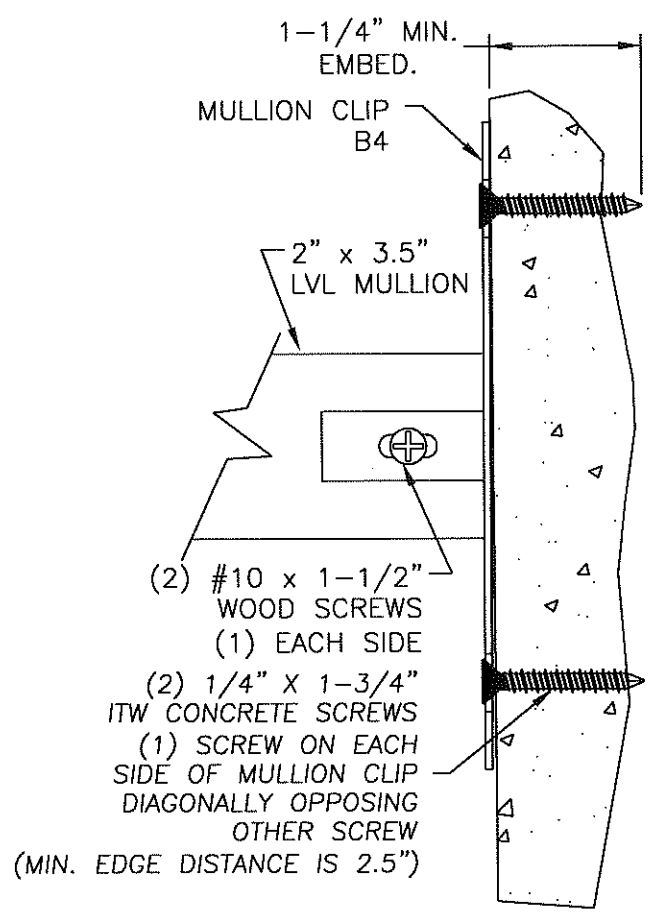

(2) 1/4" X 1-3/4" ITW CONCRETE SCREWS  
 (1) SCREW ON EACH SIDE OF MULLION CLIP DIAGONALLY OPPOSING OTHER SCREW  
 (MIN. EDGE DISTANCE IS 2.5")

ANCHOR TO MASONRY USING 1/4" X 1-3/4" ITW CONCRETE SCREWS

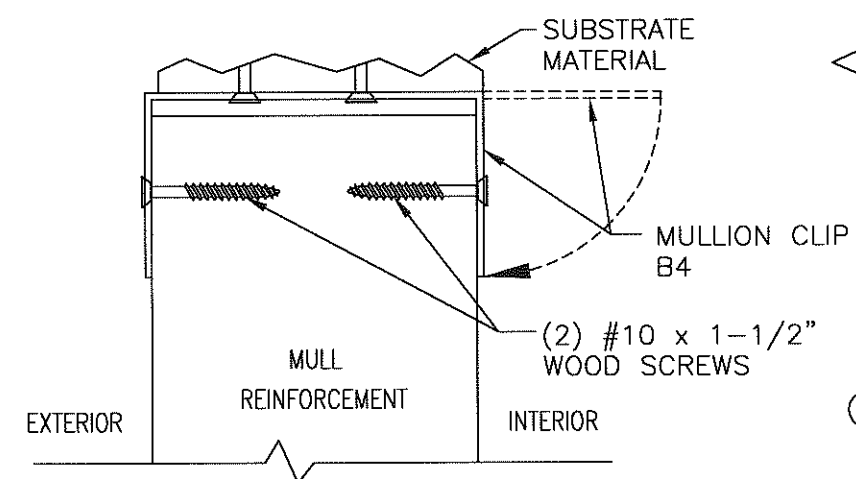

INSTALLATION PROCEDURE  
 SEE 2X, 1X TO MASONRY & MASONRY ANCHORING ABOVE

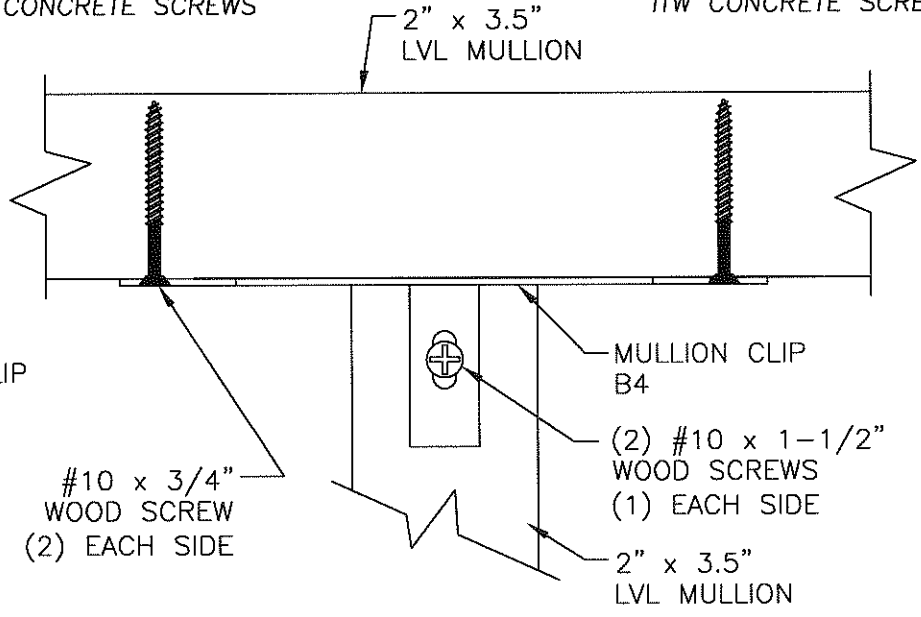

MULLION TO MULLION ANCHORING

Documents Prepared By: RW BUILDING CONSULTANTS, INC.  
 P.O. Box 230 Valrico FL 33595  
 Phone No.: 813.659.9197  
 Florida Board of Professional Engineers  
 Certificate Of Authorization No. 9813  
 Wendell W. Haney, P.E. #54158

PRODUCT:	STRUCTURAL MULLION			
PART OR ASSEMBLY:	ANCHOR PLATE DETAILS: ANCHOR CLIP B4			
NO.	DATE	REV.	TO	BY
1	9-9-08	REV. TO	2007 FBC	WH
REVISIONS				
DATE: 12/04/07				
SCALE: NTS				
DWG. BY: YV				
CHG. BY: WWH				
DRAWING NO.: FL-8566.5				
SHEET 7 OF 9				

R:\A - Projects\Project Folders\Proj 1301-1400\PF 1324\D. RWBC Drawings\FL-8566 R1\FL-8566.5\FL-8566.5-8.dwg, Model

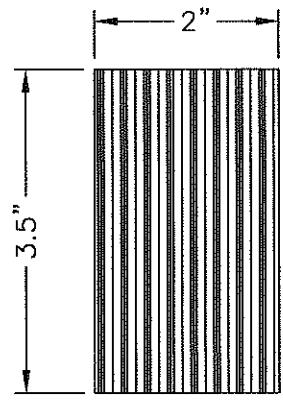

2" x 3.5" LVL MULLION

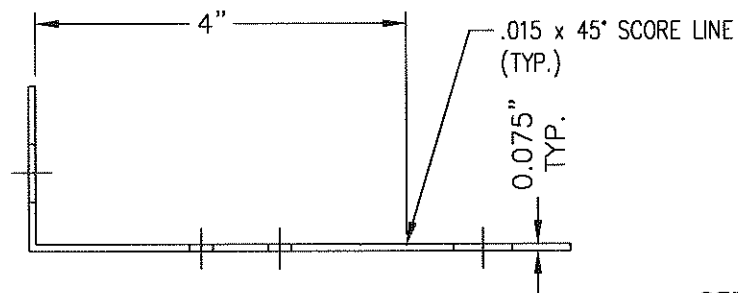
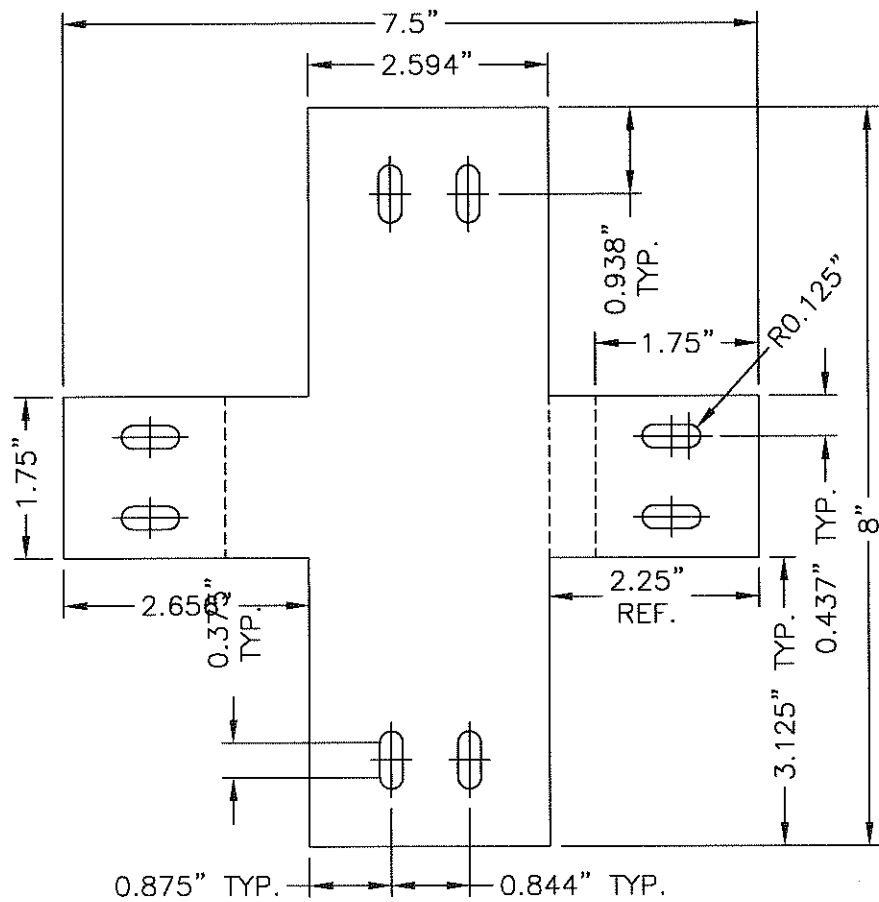

MULL CLIP - B1

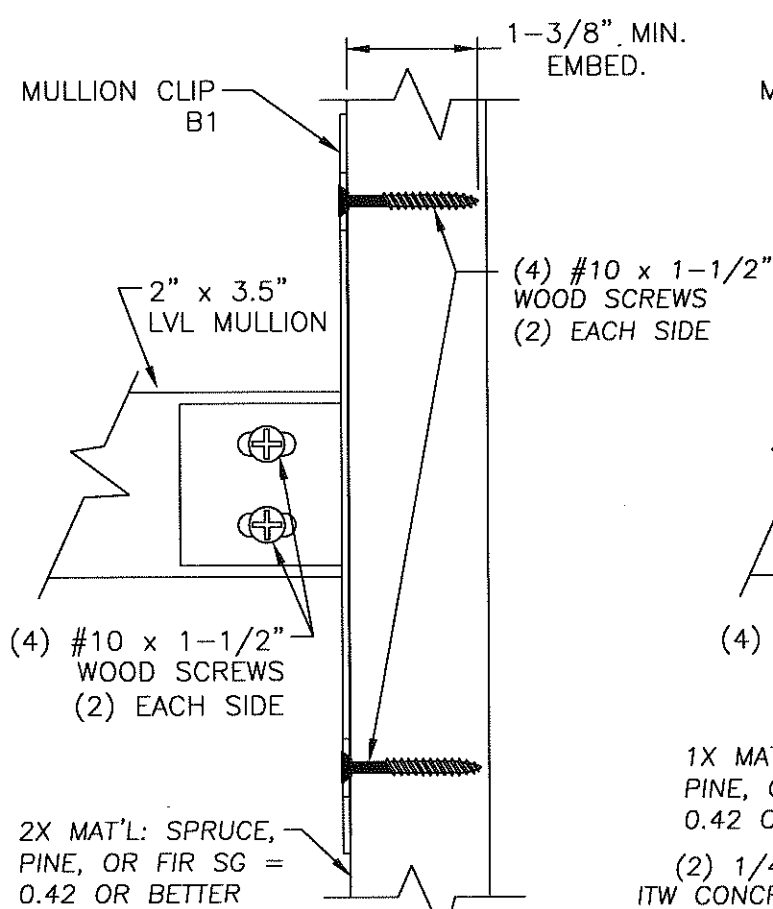

ANCHOR TO 2X

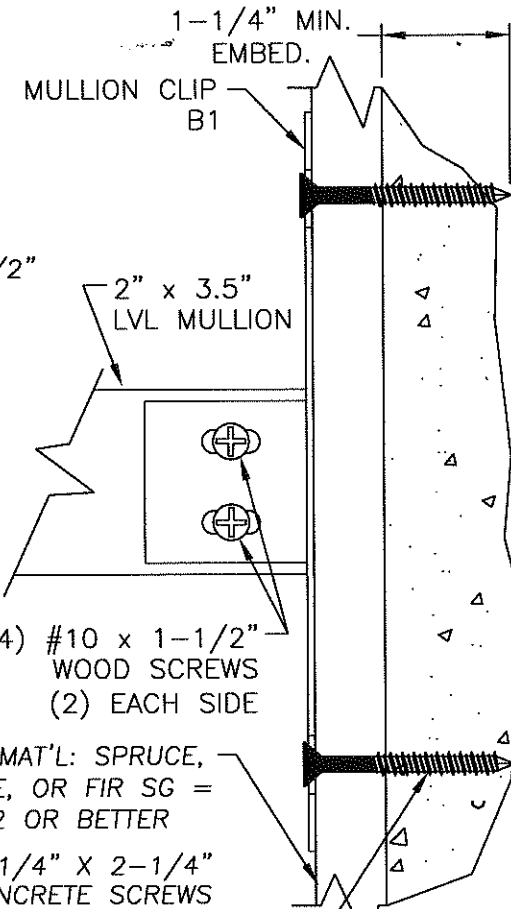

ANCHOR THROUGH 1X BUCK  
USING 1/4" X 2-1/4"  
ITW CONCRETE SCREWS

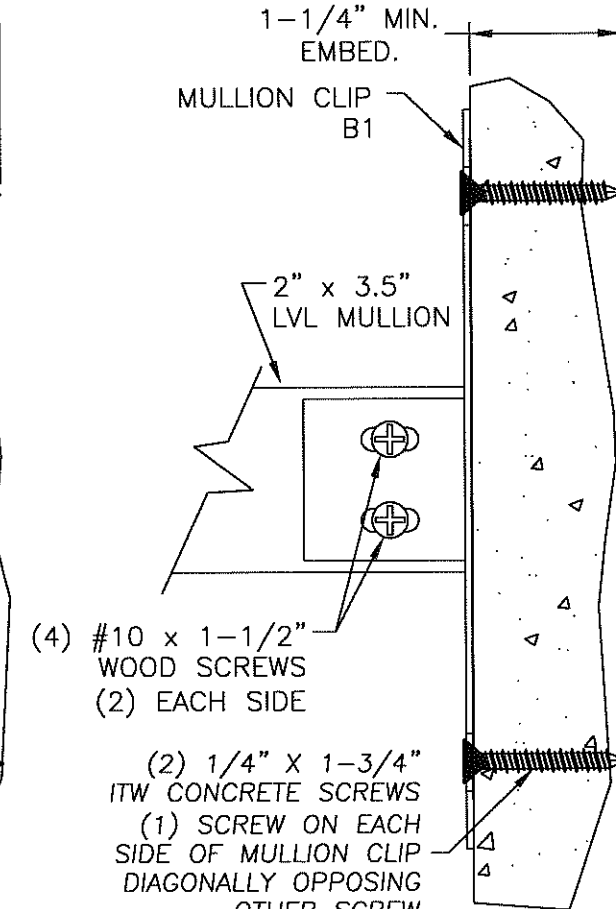

ANCHOR TO MASONRY  
USING 1/4" X 1-3/4"  
ITW CONCRETE SCREWS

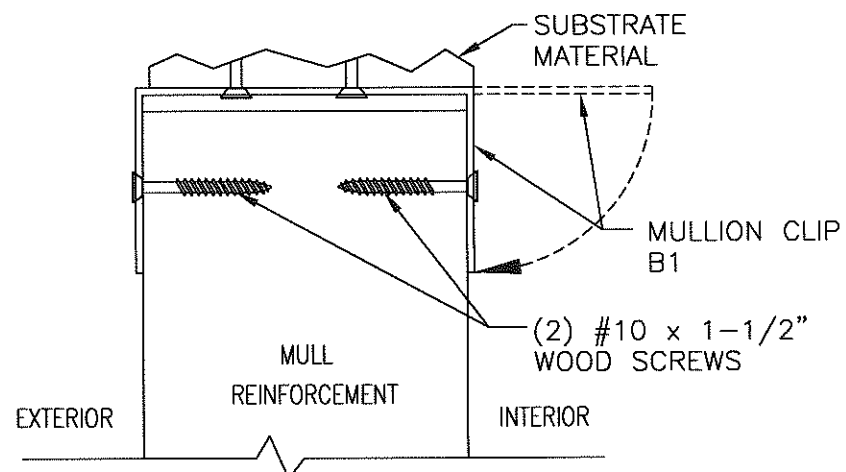

INSTALLATION PROCEDURE  
SEE 2X, 1X TO MASONRY & MASONRY ANCHORING ABOVE

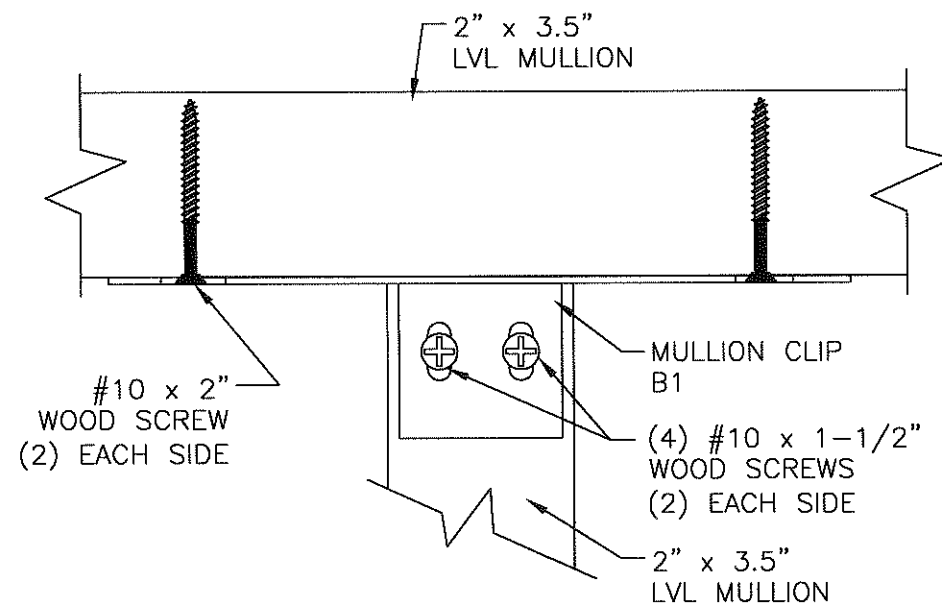

MULLION TO MULLION ANCHORING

Documents Prepared By:

**RW** BUILDING CONSULTANTS, INC.  
P.O. Box 230 Valrico FL 33595  
Phone No.: 813.659.9197  
Florida Board of Professional Engineers  
Certificate of Authorization No. 9813  
*Wendell W. Haney* 9-9-08  
Wendell W. Haney, P.E. #54158

PRODUCT:	STRUCTURAL MULLION
PART OR ASSEMBLY:	ANCHOR CLIP B1 ANCHORING DETAILS

NO.	DATE	REV. TO THE 2007 FBC	WH	BY
1	9-9-08			

DATE:	12/04/07
SCALE:	NTS
DWG. BY:	YV
CHG. BY:	WWH
DRAWING NO.:	FL-8566.5
SHEET	8 OF 9

R:\A - Projects\Project Folders\Proj 1301-1400\PF 1324\D. RWBC Drawings\FL-8566 R1\FL-8566.5\FL-8566.5-9.dwg, Model

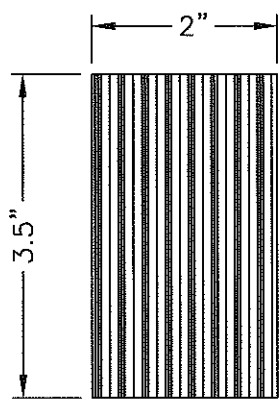

2" x 3.5" LVL MULLION

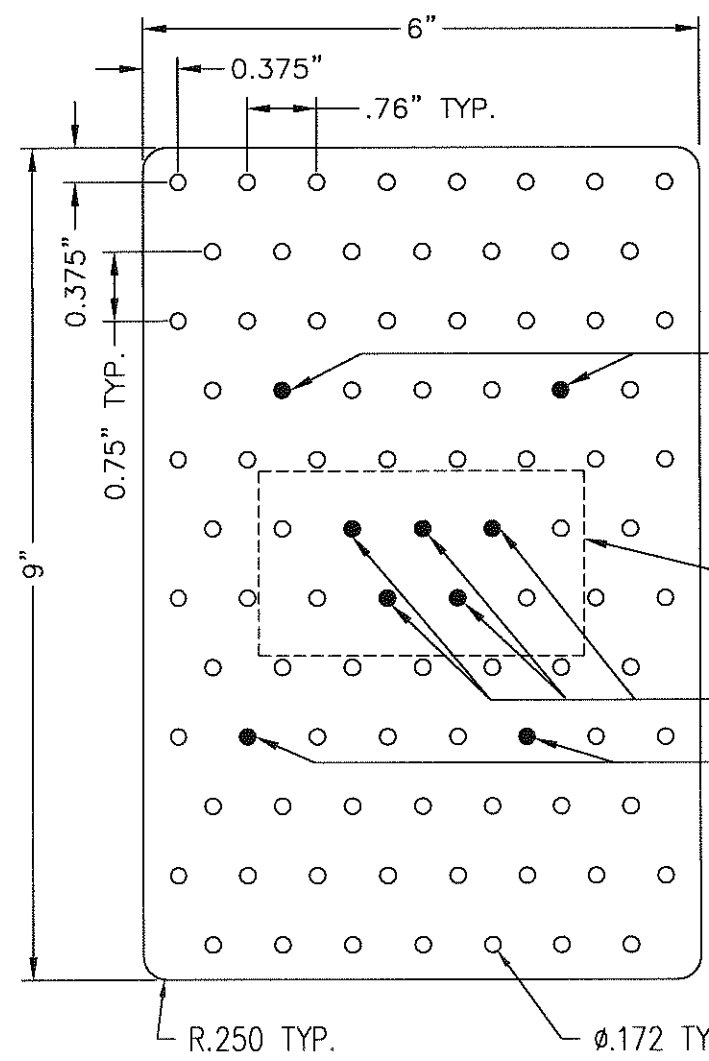

MULLION ANCHOR PLATE  
STAINLESS STEEL

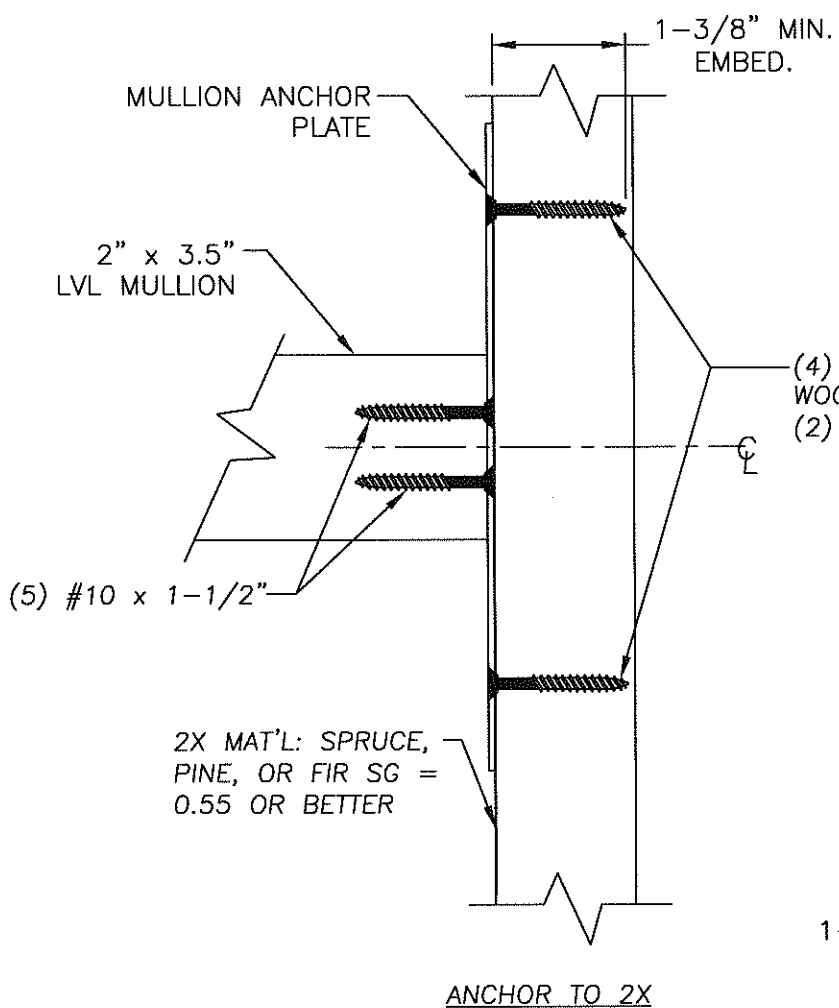

ANCHOR TO 2X

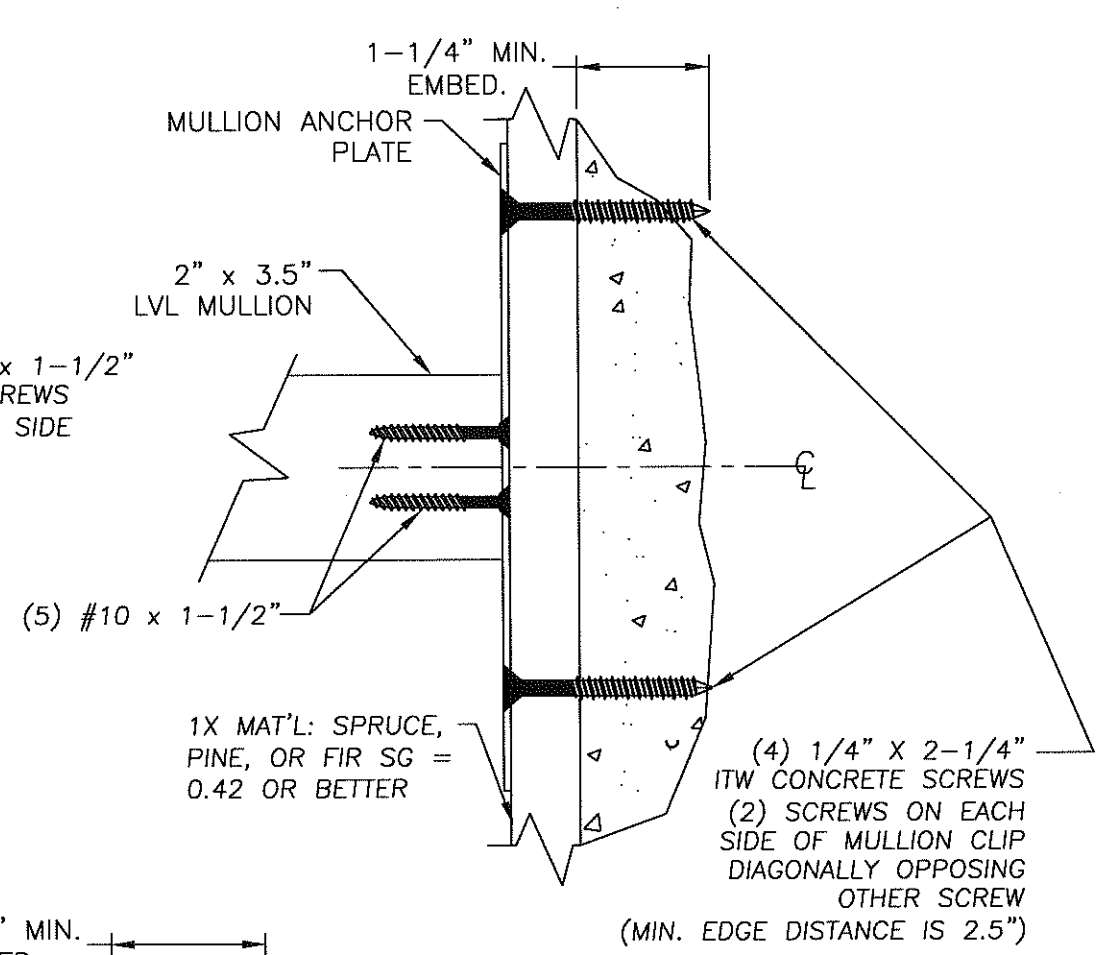

ANCHOR THROUGH 1X BUCK

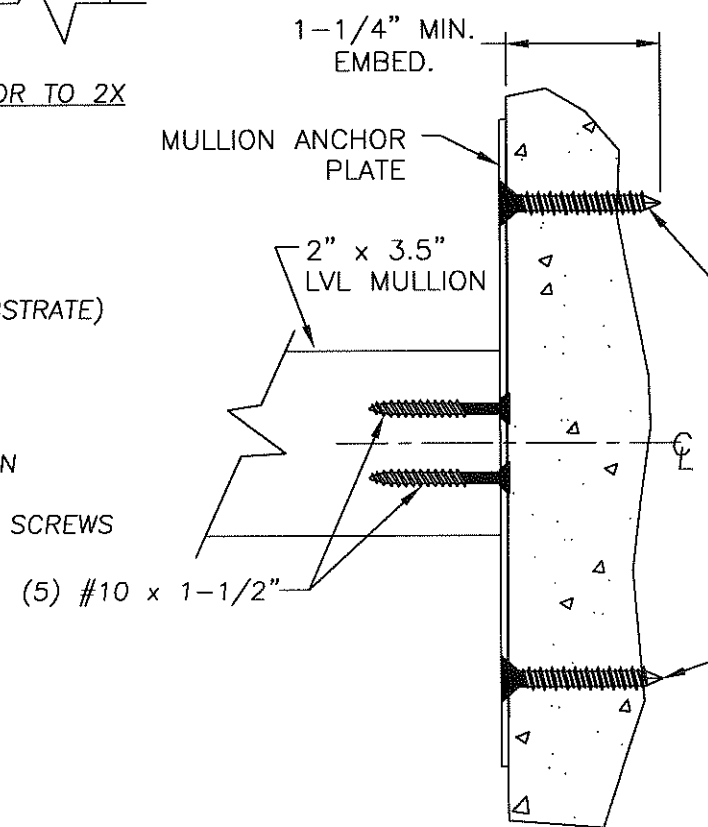

ANCHOR TO MASONRY  
USING 1/4" X 1-3/4"  
ITW CONCRETE SCREWS

Documents Prepared By:

**RW** BUILDING CONSULTANTS, INC.  
P.O. Box 230 Vairico FL 33595  
Phone No.: 813.659.9197  
Florida Board of Professional Engineers  
Certificate Of Authorization No. 9813  
Wendell W. Hapney 9-9-08  
Wendell W. Hapney, P.E. No. 54158

PRODUCT:	STRUCTURAL MULLION
PART OR ASSEMBLY:	MULLION ANCHOR PLATE ANCHORING DETAILS

NO.	DATE	REV.	TO THE 2007 FBC	WH	BY
1	9-9-08				

DATE:	12/04/07
SCALE:	NTS
DWG. BY:	YV
CHG. BY:	WWH
DRAWING NO.:	FL-8566.5
SHEET	9 OF 9