

LVL WOOD MULLION

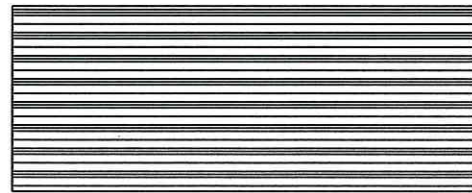

2" x 5" LVL WOOD MULLION

GENERAL NOTES:

1. THIS PRODUCT HAS BEEN EVALUATED AND IS IN COMPLIANCE WITH THE FLORIDA BUILDING CODE EXCLUDING THE "HIGH VELOCITY HURRICANE ZONE".
2. WOOD BUCKS BY OTHERS, MUST BE ANCHORED PROPERLY TO TRANSFER LOADS TO THE STRUCTURE AND BE REVIEWED BY THE BUILDING OFFICIAL.
3. MULLION ANCHOR EMBEDMENT TO BASE MATERIAL SHALL BE BEYOND WALL DRESSING OR STUCCO.
4. SEPARATE PRODUCT APPROVALS FOR EACH GLAZING PRODUCT USED WITH THESE MULLIONS MUST BE SUBMITTED ALONG WITH THIS MULLION PRODUCT APPROVAL.
5. ANCHORING OF EACH GLAZING PRODUCT TO THE MULLION SHALL BE AS SHOWN IN EACH INDIVIDUAL GLAZING PRODUCT APPROVAL.
6. SITE CONDITIONS NOT COVERED IN THIS EVALUATION ARE SUBJECT TO SEPARATE ENGINEERING EVALUATION.
7. MULLION DESIGN PRESSURE RATING, SEE LOAD RATING TABLES OF THIS DRAWING.
8. THE DESIGN PRESSURE RATING OF THE ASSEMBLY SHALL BE THE LESSER OF THE LOAD CAPACITY OF THE MULLION AS DETERMINED USING THIS APPROVAL OR THE DESIGN PRESSURE RATING OF THE INDIVIDUAL GLAZING PRODUCTS USED.
9. BOUNDING BOX DIMENSIONS FOR GEOMETRIC SHAPES MUST BE EQUAL TO OR LESS THAN THE RECTANGULAR DIMENSIONS SHOWN HEREIN.
10. IN AREAS REQUIRING WIND BORNE DEBRIS PROTECTION, WIND ZONE 4 AS DEFINED IN ASTM E1996 IS EXCLUDED UNLESS THE ASSEMBLY IS PROTECTED WITH AN IMPACT RESISTANT COVERING THAT COMPLIES WITH SECITON 1609.1.2 OF THE FBC.

SUPPORTING DOCUMENTS & EVIDENCE

1. THIS PRODUCT HAS BEEN ENGINEERED FOLLOWING ACCEPTED ENGINEERING PRACTICE CONFORMING TO THE REQUIREMENTS OF SECTION 1714.5.5 OF THE FLORIDA BUILDING CODE 2007 EDITION.

TABLE OF CONTENTS	
SHEET #	DESCRIPTION
1	TYPICAL ELEVATIONS & GENERAL NOTES
2	MULLION LOAD TABLE: CONCRETE SCREW ANCHORS CLIP B-5
3	MULLION LOAD TABLE: WOOD SCREW ANCHORS CLIP B-5
4	MULLION LOAD TABLE: CONCRETE SCREW ANCHORS CLIP B-2
5	MULLION LOAD TABLE: WOOD SCREW ANCHORS CLIP B-2
6	MULLION LOAD TABLE: WOOD OR CONCRETE SCREW ANCHOR PLATE
7	ANCHOR CLIP B-5 ANCHORING DETAILS
8	ANCHOR CLIP B-2 ANCHORING DETAILS
9	MULLION ANCHORS PLATE ANCHORING DETAILS

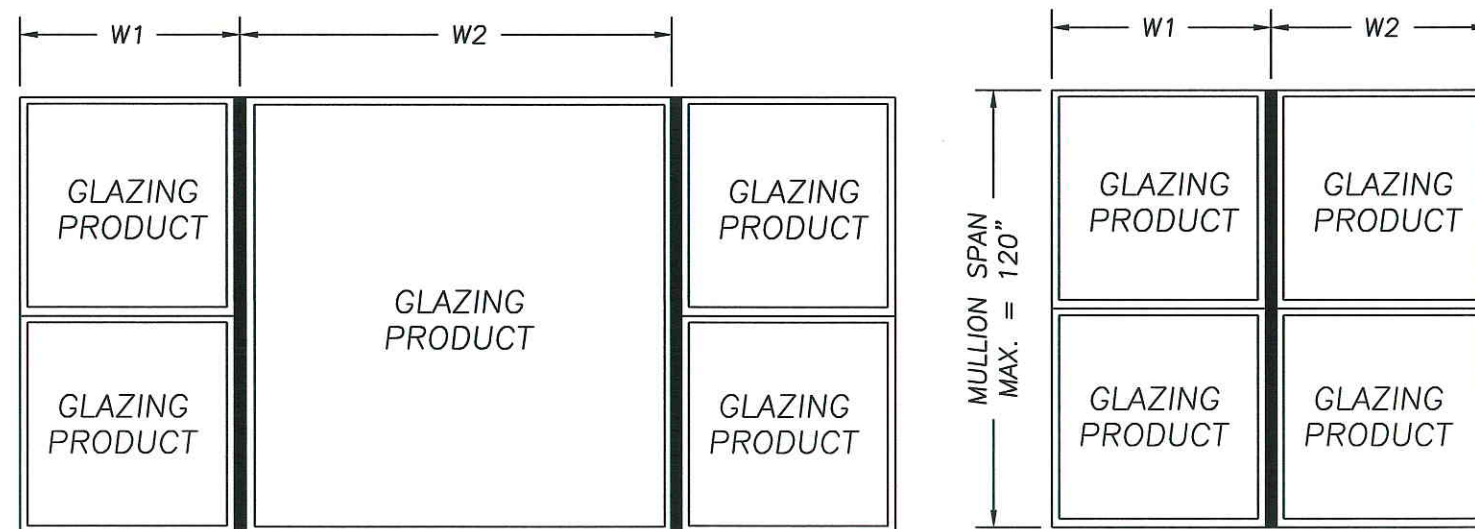
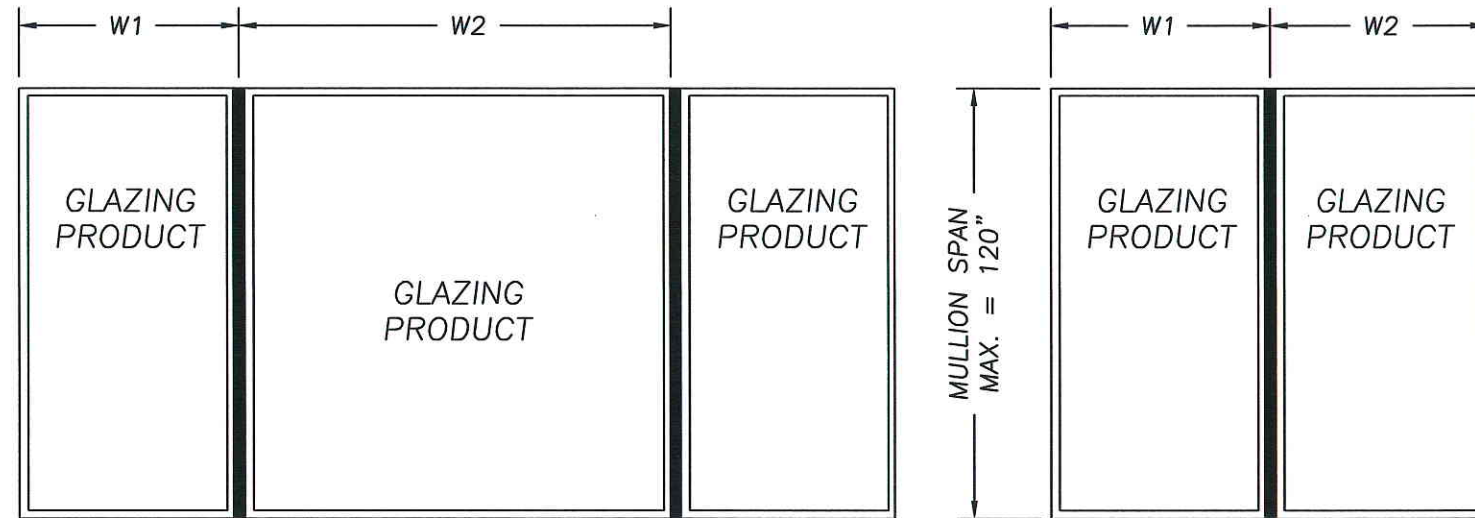

TYPICAL MULLION CONFIGURATIONS

Documents Prepared By:
RW BUILDING CONSULTANTS, INC.
 P.O. Box 230 Valrico FL 33595
 Phone No.: 813.659.9197
 Florida Board of Professional Engineers
 Certificate Of Authorization No. 9813
Wendell W. Haney 9-9-08
 Wendell W. Haney, P.E. No. 54158

PRODUCT: STRUCTURAL MULLION
 PART OR ASSEMBLY: TYPICAL ELEVATION & GENERAL NOTES

NO.	DATE	REV.	TO	WH	BY
1	9-9-08	REV.	TO 2007 FBC		

REVISIONS

DATE: 12/04/07
 SCALE: NTS
 DWG. BY: YV
 CHK. BY: WWH
 DRAWING NO.: FL-8566.7
 SHEET 1 OF 9

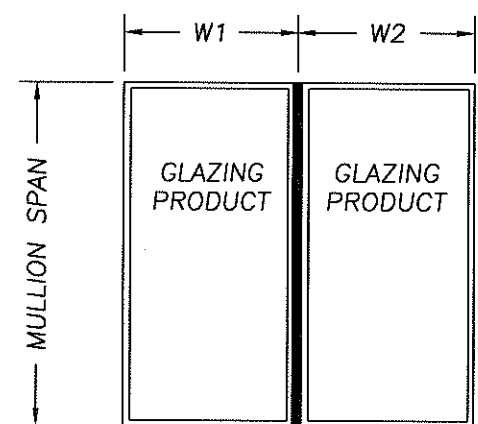

$$\text{TRIBUTARY WIDTH} = \frac{W1 + W2}{2}$$

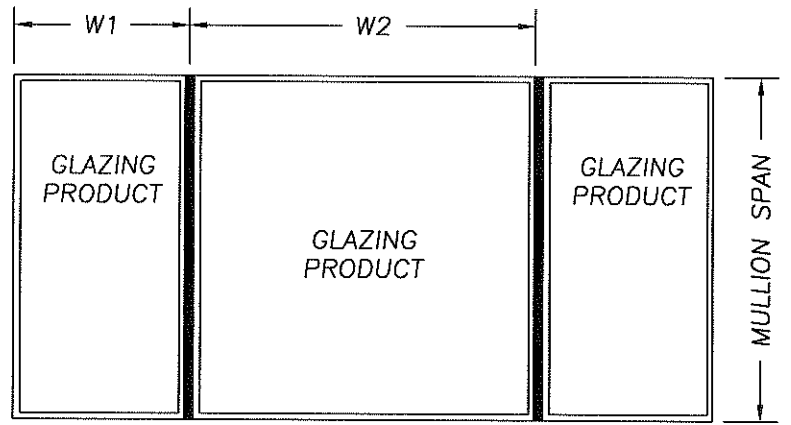

2" x 5" LVL STRUCTURAL BEAM MULLION LOAD TABLE (PSF) - ANCHOR CLIP B5

WOOD SCREW	TRIBUTARY WIDTH													
	24.0"	28.0"	30.0"	32.0"	34.0"	36.0"	38.0"	40.0"	42.0"	44.0"	46.0"	48.0"	50.0"	
MULLION SPAN	120.0"	41.89	36.58	34.47	32.63	31.00	29.57	28.29	27.14	26.11	25.18	24.33	23.56	22.86
	116.0"	43.50	38.02	35.83	33.93	32.26	30.78	29.46	28.28	27.21	26.25	25.38	24.59	23.86
	112.0"	45.24	39.57	37.31	35.34	33.61	32.09	30.72	29.50	28.41	27.42	26.52	25.70	24.96
	108.0"	47.13	41.25	38.92	36.88	35.09	33.51	32.10	30.85	29.71	28.69	27.77	26.93	26.16
	104.0"	49.17	43.09	40.67	38.56	36.71	35.07	33.61	32.31	31.15	30.09	29.14	28.28	27.49
	100.0"	51.41	45.09	42.58	40.39	38.47	36.78	35.27	33.93	32.72	31.64	30.65	29.76	28.95
	96.0"	53.86	47.29	44.68	42.41	40.42	38.67	37.11	35.72	34.47	33.35	32.33	31.42	30.57
	92.0"	56.55	49.71	47.00	44.64	42.58	40.76	39.14	37.70	36.41	35.25	34.21	33.24	32.33
	88.0"	59.53	52.40	49.58	47.13	44.98	43.09	41.41	39.92	38.58	37.39	36.29	35.25	34.27
	84.0"	62.83	55.40	52.45	49.90	47.66	45.70	43.96	42.41	41.03	39.77	38.58	37.47	36.41
	80.0"	66.53	58.75	55.68	53.02	50.69	48.65	46.84	45.24	43.78	42.41	41.13	39.92	38.78
	76.0"	70.69	62.54	59.33	56.55	54.13	52.00	50.13	48.43	46.84	45.35	43.96	42.65	41.41
	72.0"	75.40	66.86	63.49	60.59	58.06	55.85	53.86	52.00	50.27	48.65	47.13	45.70	44.35
	68.0"	80.79	71.81	68.29	65.25	62.62	60.25	58.06	56.02	54.13	52.35	50.69	49.13	47.66
	64.0"	87.00	77.55	73.86	70.69	67.86	65.25	62.83	60.59	58.50	56.55	54.73	53.02	51.41
	60.0"	94.25	84.30	80.43	77.00	73.86	70.96	68.29	65.80	63.49	61.34	59.33	57.45	55.68
	56.0"	102.82	92.33	88.13	84.30	80.79	77.55	74.57	71.81	69.24	66.86	64.63	62.54	60.59
	52.0"	113.10	101.85	97.12	92.80	88.85	85.22	81.88	78.79	75.93	73.26	70.78	68.46	66.29
	48.0"	125.67	113.10	107.71	102.82	98.35	94.25	90.48	87.00	83.78	80.79	78.00	75.40	72.97
	44.0"	141.01	126.55	120.37	114.77	109.67	105.01	100.72	96.77	93.12	89.73	86.58	83.65	80.91
	40.0"	150.00	142.86	135.72	129.26	123.38	118.02	113.10	108.58	104.40	100.53	96.94	93.60	90.48
	36.0"	150.00	150.00	150.00	147.12	140.28	134.04	128.34	123.10	118.27	113.81	109.67	105.82	102.24
	32.0"	150.00	150.00	150.00	150.00	150.00	150.00	147.52	141.38	135.72	130.50	125.67	121.18	117.00
	28.0"	150.00	150.00	150.00	150.00	150.00	150.00	150.00	150.00	150.00	150.00	146.33	141.01	136.06
	24.0"	150.00	150.00	150.00	150.00	150.00	150.00	150.00	150.00	150.00	150.00	150.00	150.00	150.00
	20.0"	150.00	150.00	150.00	150.00	150.00	150.00	150.00	150.00	150.00	150.00	150.00	150.00	150.00

INSTRUCTIONS FOR USE OF THE MULLION LOAD TABLE:

1. DETERMINE THE DESIGN LOAD REQUIREMENT PER CHAPTER 16 OF THE FBC FOR THE PARTICULAR OPENING.
2. FOR THE PARTICULAR OPENING, DETERMINE THE TRIBUTARY WIDTH AND MULLION SPAN. REFERENCE THE SKETCHES ON THIS SHEET FOR MULLION SPAN AND TRIBUTARY WIDTH DETERMINATION.
3. IN THE FIRST COLUMN OF THE TABLE, LOCATE THE MULLION SPAN. IN THE FIRST ROW OF THE TABLE, LOCATE THE TRIBUTARY WIDTH. AT THE INTERSECTION OF THE ROW CONTAINING THE MULLION SPAN AND THE COLUMN CONTAINING THE TRIBUTARY WIDTH, READ THE MULLION LOAD RATING GIVEN IN PSF. THE MULLION LOAD RATING MUST BE EQUAL TO OR GREATER THAN THE DESIGN LOAD REQUIREMENT DETERMINED IN STEP 1 ABOVE.

Documents Prepared By: **RW** BUILDING CONSULTANTS, INC.
P.O. Box 230 Valrico FL 33595
Phone No.: 813.659.9197

Florida Board of Professional Engineers
Certificate Of Authorization No. 9813
Wendell W. Hefney 9-9-08
Wendell W. Hefney, P.E. No. 54158

PRODUCT: STRUCTURAL MULLION

PART OR ASSEMBLY: MULLION LOAD TABLE: WOOD SCREW ANCHORS

NO.	DATE	WH	BY
1	9-9-08		

REVISIONS

DATE: 12/04/07

SCALE: NTS

DWG. BY: YV

CHK. BY: WWH

DRAWING NO.: FL-8566.7

SHEET 3 OF 9

R:\A - Projects\Project Folders\Proj 1301-1400\PF 1324\D. RWBC Drawings\FL-8566 R1\FL-8566.7\FL-8566.7-4.dwg, Model

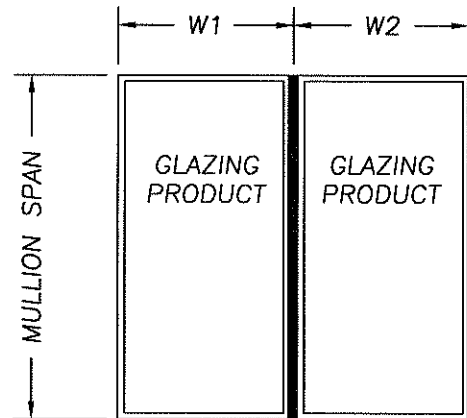

$$\text{TRIBUTARY WIDTH} = \frac{W1 + W2}{2}$$

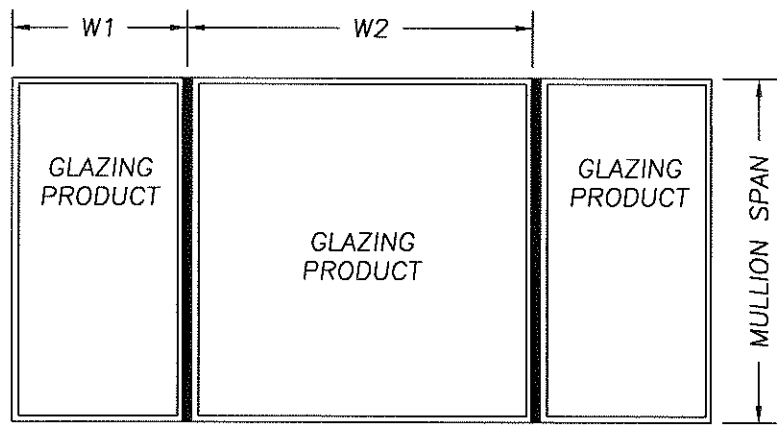

		2" x 5" LVL STRUCTURAL BEAM MULLION LOAD TABLE (PSF) - ANCHOR CLIP B2												
CONCRETE SCREW	MULLION SPAN	TRIBUTARY WIDTH												
		24.0"	28.0"	30.0"	32.0"	34.0"	36.0"	38.0"	40.0"	42.0"	44.0"	46.0"	48.0"	50.0"
120.0"		44.83	38.80	36.39	34.28	32.43	30.78	29.30	27.98	26.78	25.69	24.70	23.79	22.96
116.0"		49.73	43.06	40.39	38.06	36.00	34.18	32.55	31.08	29.75	28.55	27.45	26.45	25.53
112.0"		55.37	47.96	45.00	42.41	40.12	38.10	36.29	34.66	33.19	31.85	30.63	29.52	28.49
108.0"		61.90	53.63	50.33	47.44	44.90	42.64	40.62	38.81	37.17	35.68	34.32	33.08	31.94
104.0"		69.49	60.24	56.54	53.31	50.46	47.94	45.68	43.65	41.82	40.15	38.63	37.25	35.97
100.0"		78.38	67.97	63.82	60.19	56.99	54.15	51.61	49.33	47.27	45.40	43.70	42.14	40.71
96.0"		82.14	72.13	68.15	64.69	61.65	58.97	56.60	54.47	52.57	50.34	48.15	46.14	44.30
92.0"		86.25	75.82	71.69	68.09	64.94	62.16	59.70	57.50	55.53	53.77	52.17	50.24	48.23
88.0"		90.79	79.92	75.62	71.88	68.60	65.71	63.16	60.88	58.85	57.02	55.35	53.77	52.27
84.0"		95.83	84.49	80.00	76.10	72.70	69.70	67.04	64.69	62.59	60.66	58.85	57.14	55.53
80.0"		101.47	89.61	84.92	80.86	77.31	74.19	71.44	69.00	66.77	64.69	62.73	60.88	59.14
76.0"		107.81	95.39	90.49	86.25	82.55	79.31	76.45	73.86	71.44	69.17	67.04	65.04	63.16
72.0"		115.00	101.97	96.84	92.41	88.56	85.19	82.14	79.31	76.67	74.19	71.88	69.70	67.65
68.0"		123.21	109.52	104.15	99.52	95.50	91.90	88.56	85.45	82.55	79.85	77.31	74.93	72.70
64.0"		132.69	118.29	112.65	107.81	103.50	99.52	95.83	92.41	89.22	86.25	83.47	80.86	78.41
60.0"		143.75	128.57	122.67	117.45	112.65	108.24	104.15	100.36	96.84	93.56	90.49	87.62	84.92
56.0"		150.00	140.82	134.42	128.57	123.21	118.29	113.74	109.52	105.61	101.97	98.57	95.39	92.41
52.0"		150.00	150.00	148.12	141.54	135.52	129.98	124.89	120.17	115.80	111.74	107.95	104.41	101.10
48.0"		150.00	150.00	150.00	150.00	150.00	143.75	138.00	132.69	127.78	123.21	118.97	115.00	111.29
44.0"		150.00	150.00	150.00	150.00	150.00	150.00	150.00	147.59	142.02	136.86	132.06	127.58	123.40
40.0"		150.00	150.00	150.00	150.00	150.00	150.00	150.00	150.00	150.00	150.00	147.86	142.76	138.00
36.0"		150.00	150.00	150.00	150.00	150.00	150.00	150.00	150.00	150.00	150.00	150.00	150.00	150.00
32.0"		150.00	150.00	150.00	150.00	150.00	150.00	150.00	150.00	150.00	150.00	150.00	150.00	150.00
28.0"		150.00	150.00	150.00	150.00	150.00	150.00	150.00	150.00	150.00	150.00	150.00	150.00	150.00
24.0"		150.00	150.00	150.00	150.00	150.00	150.00	150.00	150.00	150.00	150.00	150.00	150.00	150.00
20.0"		150.00	150.00	150.00	150.00	150.00	150.00	150.00	150.00	150.00	150.00	150.00	150.00	150.00

- INSTRUCTIONS FOR USE OF THE MULLION LOAD TABLE:**
1. DETERMINE THE DESIGN LOAD REQUIREMENT PER CHAPTER 16 OF THE FBC FOR THE PARTICULAR OPENING.
 2. FOR THE PARTICULAR OPENING, DETERMINE THE TRIBUTARY WIDTH AND MULLION SPAN. REFERENCE THE SKETCHES ON THIS SHEET FOR MULLION SPAN AND TRIBUTARY WIDTH DETERMINATION.
 3. IN THE FIRST COLUMN OF THE TABLE, LOCATE THE MULLION SPAN. IN THE FIRST ROW OF THE TABLE, LOCATE THE TRIBUTARY WIDTH. AT THE INTERSECTION OF THE ROW CONTAINING THE MULLION SPAN AND THE COLUMN CONTAINING THE TRIBUTARY WIDTH, READ THE MULLION LOAD RATING GIVEN IN PSF. THE MULLION LOAD RATING MUST BE EQUAL TO OR GREATER THAN THE DESIGN LOAD REQUIREMENT DETERMINED IN STEP 1 ABOVE.

Documents Prepared By: **RW** BUILDING CONSULTANTS, INC.
P.O. Box 230 Vairico FL 33595
Phone No.: 813.659.9197

Florida Board of Professional Engineers
Certificate Of Authorization No. 9813
Wendell W. Honey, P.E. No. 54158

DATE: 12/04/07
SCALE: NTS
DWG. BY: YV
CHK. BY: WWH
DRAWING NO.: FL-8566.7
SHEET 4 OF 9

PRODUCT: STRUCTURAL MULLION
PART OR ASSEMBLY: MULLION LOAD TABLE: CONCRETE SCREW ANCHORS

NO. DATE REV. TO 2007 FBC REVISIONS
1 9-9-08 REV. TO 2007 FBC
BY

R:\A - Projects\Project Folders\Proj 1301-1400\PF 1324\D. RWBC Drawings\FL-8566 R1\FL-8566.7\FL-8566.7-5.dwg, Model

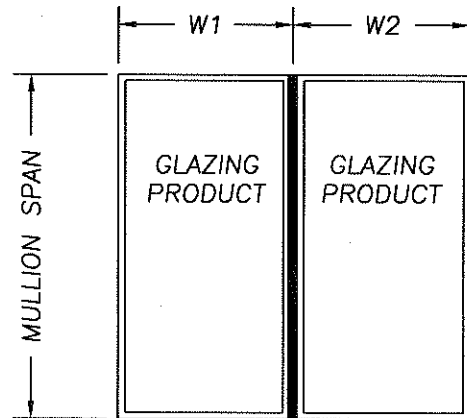

$$\text{TRIBUTARY WIDTH} = \frac{W1 + W2}{2}$$

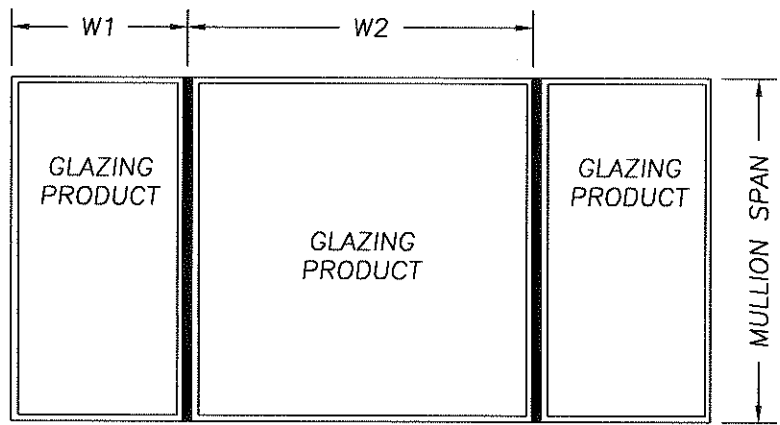

		2" x 5" LVL STRUCTURAL BEAM MULLION LOAD TABLE (PSF) - ANCHOR CLIP B2												
WOOD SCREW	MULLION SPAN	TRIBUTARY WIDTH												
		24.0"	28.0"	30.0"	32.0"	34.0"	36.0"	38.0"	40.0"	42.0"	44.0"	46.0"	48.0"	50.0"
120.0"		44.83	38.80	36.39	34.28	32.43	30.78	29.30	27.98	26.78	25.69	24.70	23.79	22.96
116.0"		49.73	43.06	40.39	38.06	36.00	34.18	32.55	31.08	29.75	28.55	27.45	26.45	25.53
112.0"		55.37	47.96	45.00	42.41	40.12	38.10	36.29	34.66	33.19	31.85	30.63	29.52	28.49
108.0"		61.90	53.63	50.33	47.44	44.90	42.64	40.62	38.81	37.17	35.68	34.32	33.08	31.94
104.0"		69.49	60.24	56.54	53.31	50.46	47.94	45.68	43.65	41.82	40.15	38.63	37.25	35.97
100.0"		78.38	67.97	63.82	60.19	56.99	54.15	51.61	49.33	47.27	45.40	43.70	42.14	40.71
96.0"		82.14	72.13	68.15	64.69	61.65	58.97	56.60	54.47	52.57	50.34	48.15	46.14	44.30
92.0"		86.25	75.82	71.69	68.09	64.94	62.16	59.70	57.50	55.53	53.77	52.17	50.24	48.23
88.0"		90.79	79.92	75.62	71.88	68.60	65.71	63.16	60.88	58.85	57.02	55.35	53.77	52.27
84.0"		95.83	84.49	80.00	76.10	72.70	69.70	67.04	64.69	62.59	60.66	58.85	57.14	55.53
80.0"		101.47	89.61	84.92	80.86	77.31	74.19	71.44	69.00	66.77	64.69	62.73	60.88	59.14
76.0"		107.81	95.39	90.49	86.25	82.55	79.31	76.45	73.86	71.44	69.17	67.04	65.04	63.16
72.0"		115.00	101.97	96.84	92.41	88.56	85.19	82.14	79.31	76.67	74.19	71.88	69.70	67.65
68.0"		123.21	109.52	104.15	99.52	95.50	91.90	88.56	85.45	82.55	79.85	77.31	74.93	72.70
64.0"		132.69	118.29	112.65	107.81	103.50	99.52	95.83	92.41	89.22	86.25	83.47	80.86	78.41
60.0"		143.75	128.57	122.67	117.45	112.65	108.24	104.15	100.36	96.84	93.56	90.49	87.62	84.92
56.0"		150.00	140.82	134.42	128.57	123.21	118.29	113.74	109.52	105.61	101.97	98.57	95.39	92.41
52.0"		150.00	150.00	148.12	141.54	135.52	129.98	124.89	120.17	115.80	111.74	107.95	104.41	101.10
48.0"		150.00	150.00	150.00	150.00	150.00	150.00	143.75	138.00	132.69	127.78	123.21	118.97	115.00
44.0"		150.00	150.00	150.00	150.00	150.00	150.00	150.00	147.59	142.02	136.86	132.06	127.58	123.40
40.0"		150.00	150.00	150.00	150.00	150.00	150.00	150.00	150.00	150.00	150.00	147.86	142.76	138.00
36.0"		150.00	150.00	150.00	150.00	150.00	150.00	150.00	150.00	150.00	150.00	150.00	150.00	150.00
32.0"		150.00	150.00	150.00	150.00	150.00	150.00	150.00	150.00	150.00	150.00	150.00	150.00	150.00
28.0"		150.00	150.00	150.00	150.00	150.00	150.00	150.00	150.00	150.00	150.00	150.00	150.00	150.00
24.0"		150.00	150.00	150.00	150.00	150.00	150.00	150.00	150.00	150.00	150.00	150.00	150.00	150.00
20.0"		150.00	150.00	150.00	150.00	150.00	150.00	150.00	150.00	150.00	150.00	150.00	150.00	150.00

- INSTRUCTIONS FOR USE OF THE MULLION LOAD TABLE:**
1. DETERMINE THE DESIGN LOAD REQUIREMENT PER CHAPTER 16 OF THE FBC FOR THE PARTICULAR OPENING.
 2. FOR THE PARTICULAR OPENING, DETERMINE THE TRIBUTARY WIDTH AND MULLION SPAN. REFERENCE THE SKETCHES ON THIS SHEET FOR MULLION SPAN AND TRIBUTARY WIDTH DETERMINATION.
 3. IN THE FIRST COLUMN OF THE TABLE, LOCATE THE MULLION SPAN. IN THE FIRST ROW OF THE TABLE, LOCATE THE TRIBUTARY WIDTH. AT THE INTERSECTION OF THE ROW CONTAINING THE MULLION SPAN AND THE COLUMN CONTAINING THE TRIBUTARY WIDTH, READ THE MULLION LOAD RATING GIVEN IN PSF. THE MULLION LOAD RATING MUST BE EQUAL TO OR GREATER THAN THE DESIGN LOAD REQUIREMENT DETERMINED IN STEP 1 ABOVE.

Documents Prepared By: **RW BUILDING CONSULTANTS, INC.**
P.O. Box 230 Valrico FL 33595
Phone No.: 813.659.9197

Florida Board of Professional Engineers
Certificate of Authorization No. 9813
Wendell W. Haney 9-9-08
Wendell W. Haney, P.E. No. 54158

PRODUCT:	STRUCTURAL MULLION		
PART OR ASSEMBLY:	MULLION LOAD TABLE: WOOD SCREW ANCHORS		
NO.	DATE	REV.	TO
1	9-9-08	REV. TO	2007 FBC
REVISIONS			

DATE: 12/04/07
SCALE: NTS
DWG. BY: YV
CHK. BY: WWH
DRAWING NO.: FL-8566.7
SHEET 5 OF 9

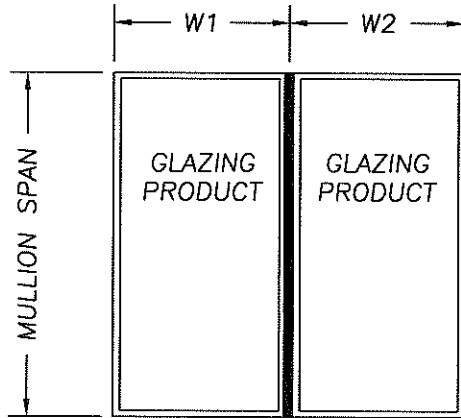

$$\text{TRIBUTARY WIDTH} = \frac{W1 + W2}{2}$$

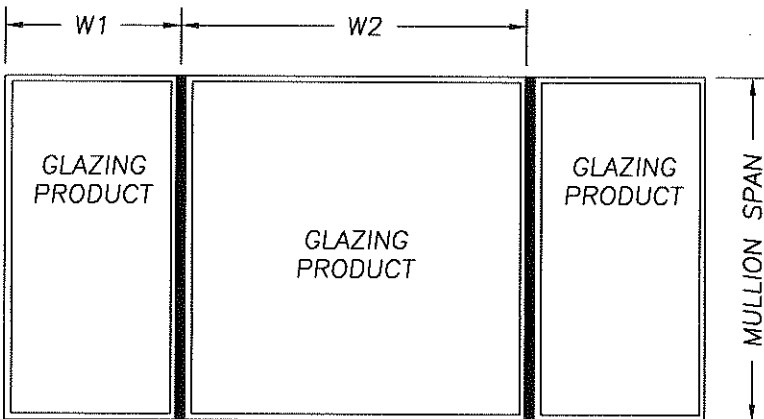

WOOD OR CONCRETE SCREW	2" x 5" LVL STRUCTURAL BEAM MULLION LOAD TABLE (PSF) - ANCHOR PLATE													
	TRIBUTARY WIDTH													
	24.0"	28.0"	30.0"	32.0"	34.0"	36.0"	38.0"	40.0"	42.0"	44.0"	46.0"	48.0"	50.0"	
120.0"	44.83	38.80	36.39	34.28	32.43	30.78	29.30	27.98	26.78	25.69	24.70	23.79	22.96	
116.0"	49.73	43.06	40.39	38.06	36.00	34.18	32.55	31.08	29.75	28.55	27.45	26.45	25.53	
112.0"	55.37	47.96	45.00	42.41	40.12	38.10	36.29	34.66	33.19	31.85	30.63	29.52	28.49	
108.0"	61.90	53.63	50.33	47.44	44.90	42.64	40.62	38.81	37.17	35.68	34.32	33.08	31.94	
104.0"	69.49	60.24	56.54	53.31	50.46	47.94	45.68	43.65	41.82	40.15	38.63	37.25	35.97	
100.0"	78.38	67.97	63.82	60.19	56.99	54.15	51.61	49.33	47.27	45.40	43.70	42.14	40.71	
96.0"	88.85	77.10	72.40	68.30	64.69	61.48	58.29	55.37	52.74	50.34	48.15	46.14	44.30	
92.0"	100.49	86.13	80.39	75.37	70.93	66.99	63.47	60.29	57.42	54.81	52.43	50.24	48.23	
88.0"	109.83	94.14	87.86	82.37	77.53	73.22	69.37	65.90	62.76	59.91	57.30	54.92	52.72	
84.0"	120.54	103.32	96.43	90.41	85.09	80.36	76.13	72.32	68.88	65.75	62.89	60.27	57.86	
80.0"	132.90	113.91	106.32	99.67	93.81	88.60	83.93	79.74	75.94	72.49	69.34	66.45	63.79	
76.0"	147.25	126.22	117.80	110.44	103.94	98.17	93.00	88.35	84.14	80.32	76.83	73.63	70.68	
72.0"	150.00	140.63	131.25	123.05	115.81	109.38	103.62	98.44	93.75	89.49	85.60	82.03	78.75	
68.0"	150.00	150.00	147.15	137.95	129.84	122.63	116.17	110.36	105.11	100.33	95.97	91.97	88.29	
64.0"	150.00	150.00	150.00	150.00	146.58	138.43	131.15	124.59	118.66	113.26	108.34	103.82	99.67	
60.0"	150.00	150.00	150.00	150.00	150.00	150.00	149.22	141.76	135.00	128.87	123.27	118.13	113.40	
56.0"	150.00	150.00	150.00	150.00	150.00	150.00	150.00	150.00	150.00	147.94	141.50	135.61	130.18	
52.0"	150.00	150.00	150.00	150.00	150.00	150.00	150.00	150.00	150.00	150.00	150.00	150.00	149.80	
48.0"	150.00	150.00	150.00	150.00	150.00	150.00	150.00	150.00	150.00	150.00	150.00	150.00	150.00	
44.0"	150.00	150.00	150.00	150.00	150.00	150.00	150.00	150.00	150.00	150.00	150.00	150.00	150.00	
40.0"	150.00	150.00	150.00	150.00	150.00	150.00	150.00	150.00	150.00	150.00	150.00	150.00	150.00	
36.0"	150.00	150.00	150.00	150.00	150.00	150.00	150.00	150.00	150.00	150.00	150.00	150.00	150.00	
32.0"	150.00	150.00	150.00	150.00	150.00	150.00	150.00	150.00	150.00	150.00	150.00	150.00	150.00	
28.0"	150.00	150.00	150.00	150.00	150.00	150.00	150.00	150.00	150.00	150.00	150.00	150.00	150.00	
24.0"	150.00	150.00	150.00	150.00	150.00	150.00	150.00	150.00	150.00	150.00	150.00	150.00	150.00	
20.0"	150.00	150.00	150.00	150.00	150.00	150.00	150.00	150.00	150.00	150.00	150.00	150.00	150.00	

INSTRUCTIONS FOR USE OF THE MULLION LOAD TABLE:

1. DETERMINE THE DESIGN LOAD REQUIREMENT PER CHAPTER 16 OF THE FBC FOR THE PARTICULAR OPENING.
2. FOR THE PARTICULAR OPENING, DETERMINE THE TRIBUTARY WIDTH AND MULLION SPAN. REFERENCE THE SKETCHES ON THIS SHEET FOR MULLION SPAN AND TRIBUTARY WIDTH DETERMINATION.
3. IN THE FIRST COLUMN OF THE TABLE, LOCATE THE MULLION SPAN. IN THE FIRST ROW OF THE TABLE, LOCATE THE TRIBUTARY WIDTH. AT THE INTERSECTION OF THE ROW CONTAINING THE MULLION SPAN AND THE COLUMN CONTAINING THE TRIBUTARY WIDTH, READ THE MULLION LOAD RATING GIVEN IN PSF. THE MULLION LOAD RATING MUST BE EQUAL TO OR GREATER THAN THE DESIGN LOAD REQUIREMENT DETERMINED IN STEP 1 ABOVE.

Documents Prepared By: **RW** BUILDING CONSULTANTS, INC.
P.O. Box 230 Valrico FL 33595
Phone No.: 813.659.9197

Florida Board of Professional Engineers
Certificate Of Authorization No. 9813
Wendell W. Haney, P.E. No. 54158

DATE: 12/04/07
SCALE: NTS
DWG. BY: YV
CHK. BY: WWH
DRAWING NO.: FL-8566.7
SHEET 6 OF 9

PRODUCT: STRUCTURAL MULLION
PART OR ASSEMBLY: MULLION LOAD TABLE: WOOD OR CONCRETE SCREW ANCHOR PLATE

NO.	DATE	REV. TO	BY
1	9-9-08	REV. TO 2007 FBC	WH

REVISIONS

R:\A - Projects\Project Folders\Proj 1301-1400\PF 1324\ID. RWBC Drawings\FL-8566 R1\FL-8566.7\FL-8566.7-7.dwg, Model

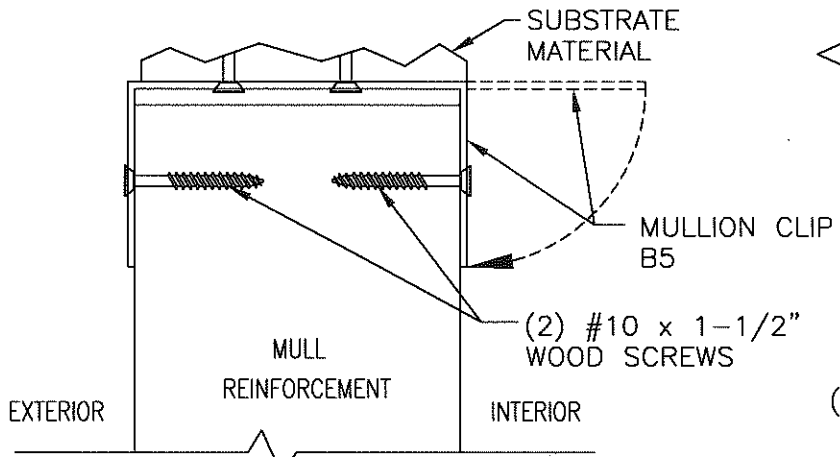
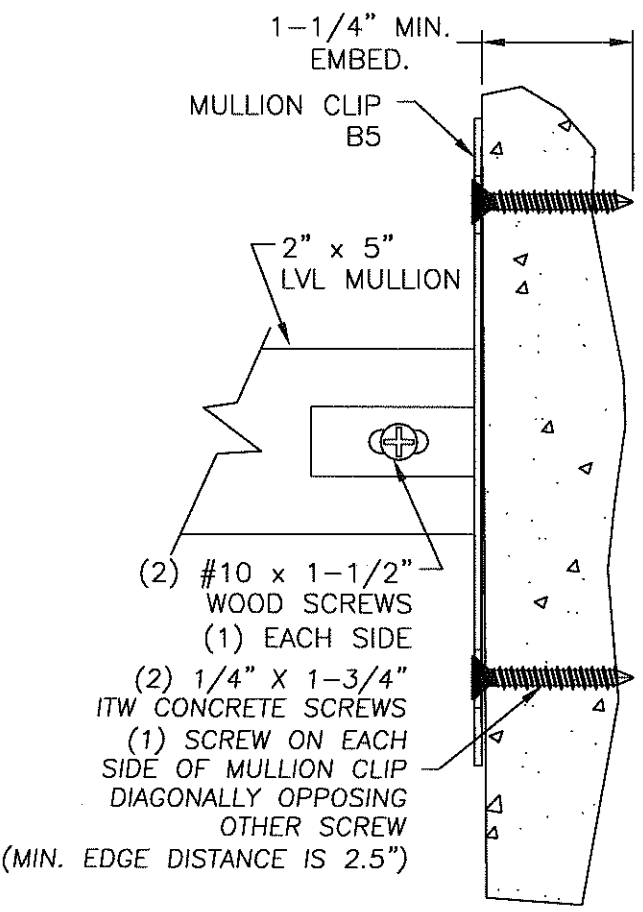
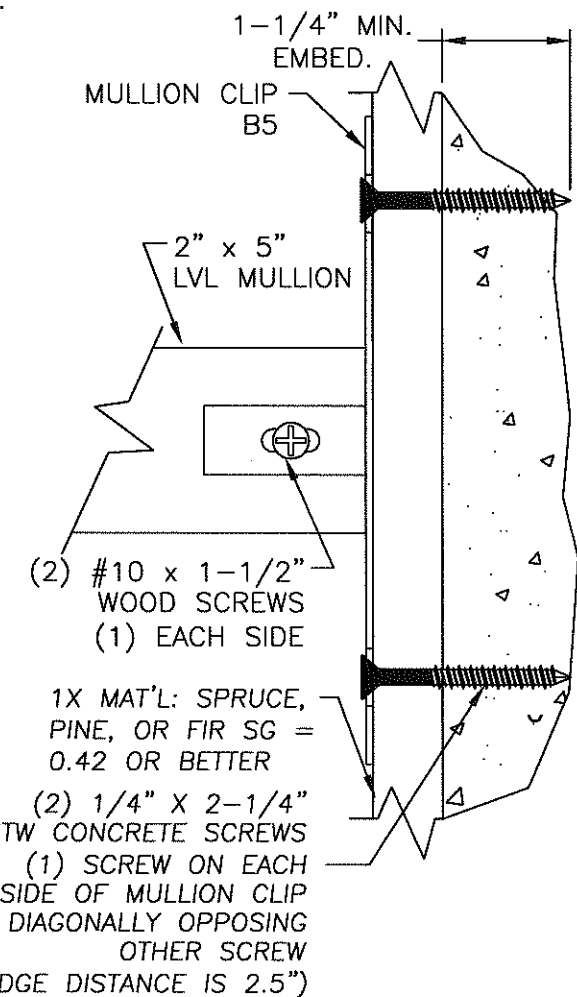
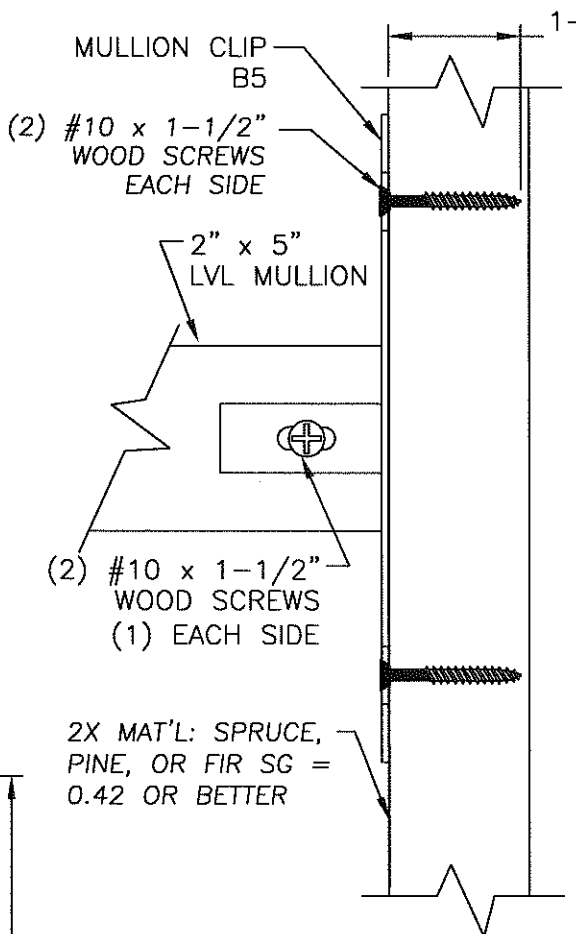
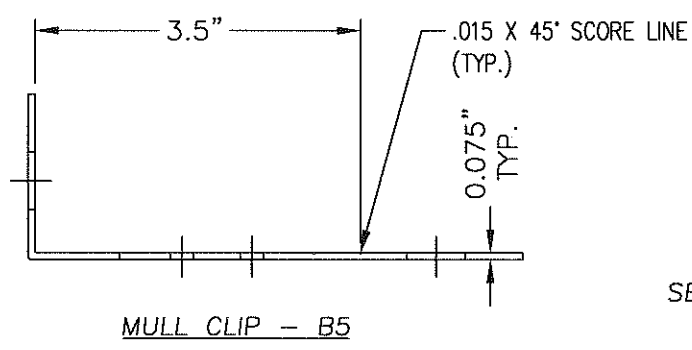
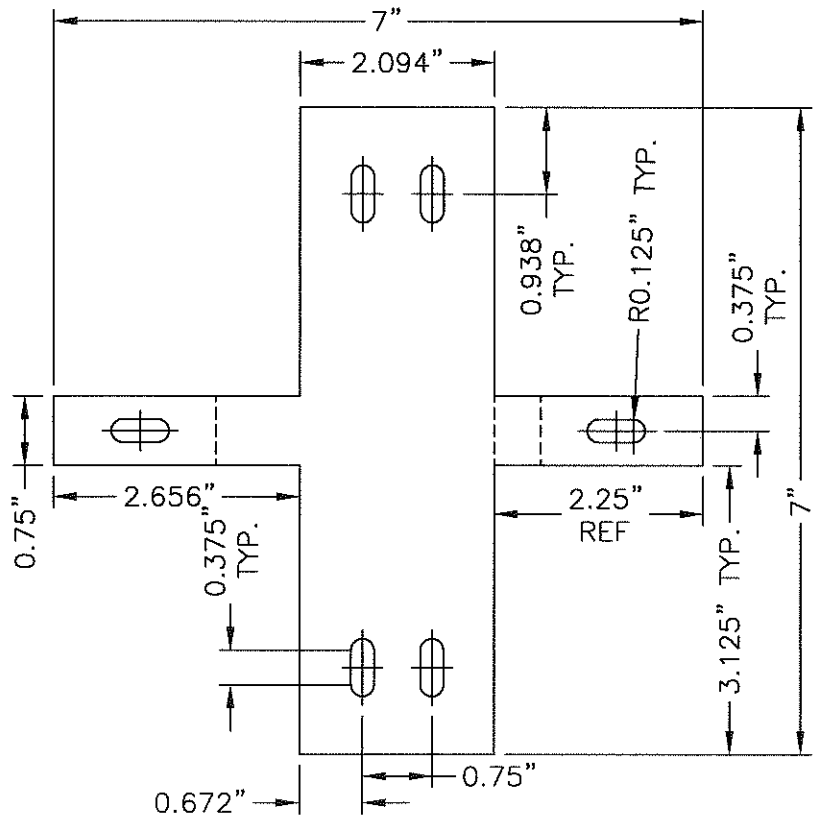
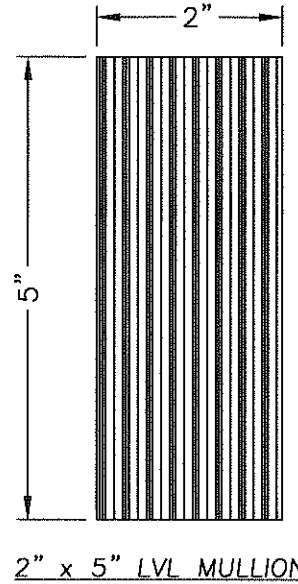

INSTALLATION PROCEDURE
SEE 2X, 1X TO MASONRY & MASONRY ANCHORING ABOVE

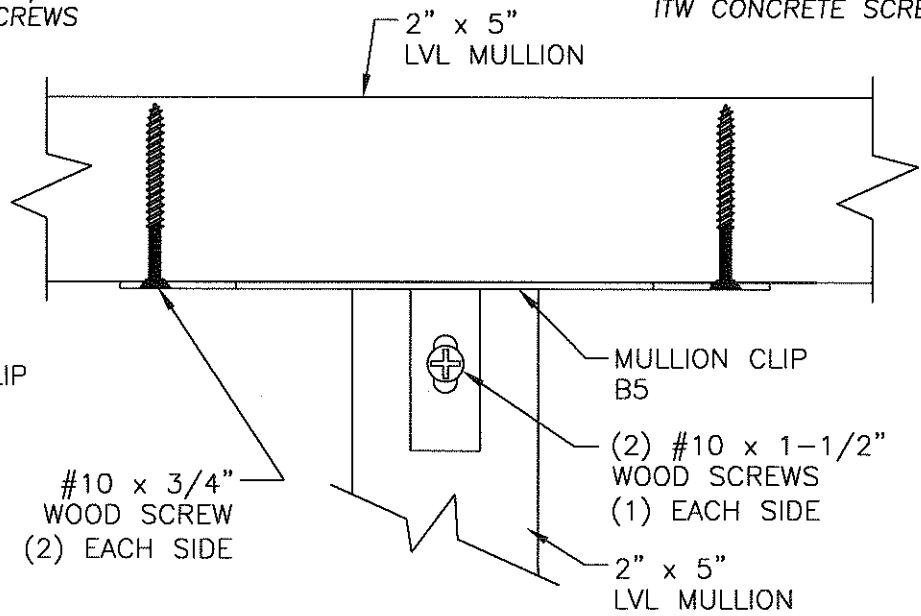

Documents Prepared By:
RW BUILDING CONSULTANTS, INC.
 P.O. Box 230 Valrico FL 33595
 Phone No.: 813.659.9197
 Florida Board of Professional Engineers
 Certificate of Authorization No. 9813
Wendell W. Haney 9-9-08
 Wendell W. Haney, P.E. #54158

PRODUCT:	STRUCTURAL MULLION
PART OR ASSEMBLY:	ANCHOR CLIP B5 ANCHORING DETAILS

NO.	DATE	REV. TO THE 2007 FBC	WH	BY
1	9-9-08			

DATE: 12/04/07
 SCALE: NTS
 DWG. BY: YV
 CHG. BY: WWH
 DRAWING NO.: FL-8566.7
 SHEET 7 OF 9

R:\A - Projects\Project Folders\Proj 1301-1400\PF 1324\ID. RWBC Drawings\FL-8566 R1\FL-8566.7\FL-8566.7-8.dwg, Model

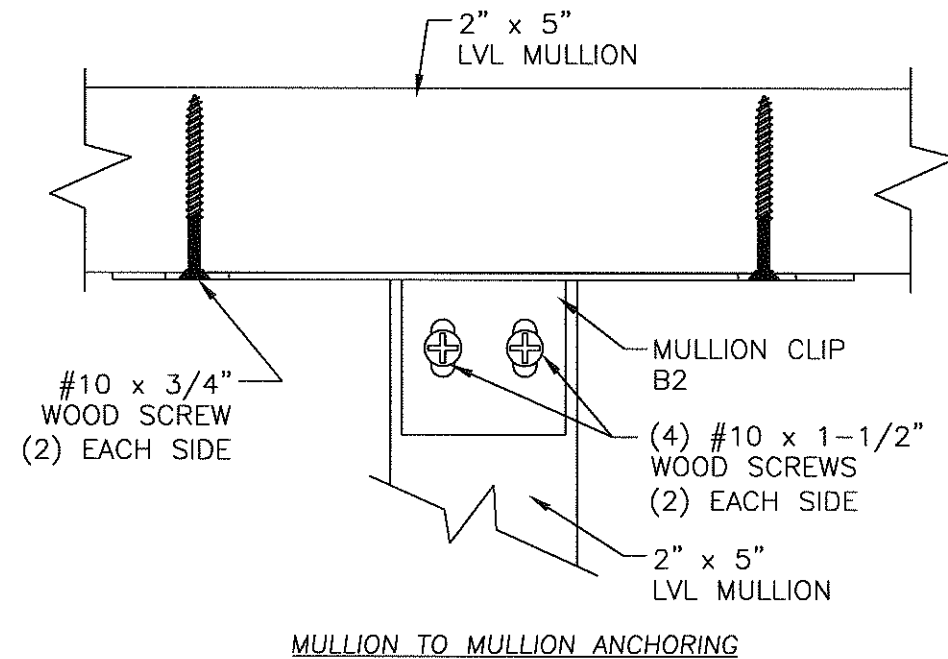
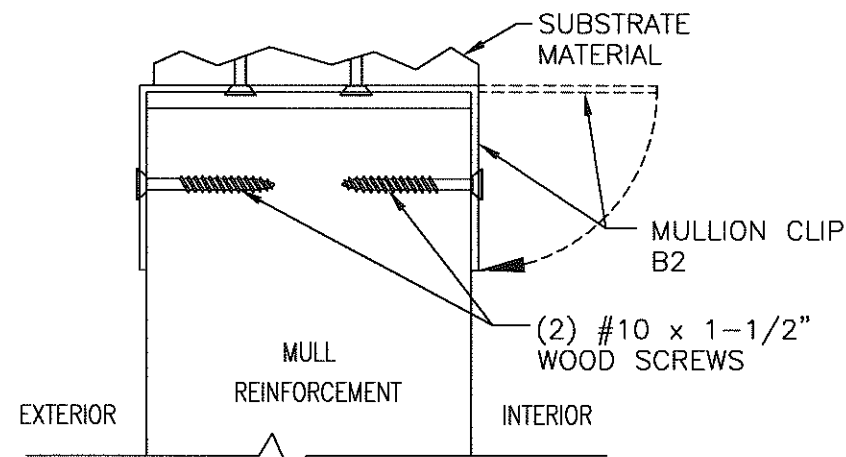
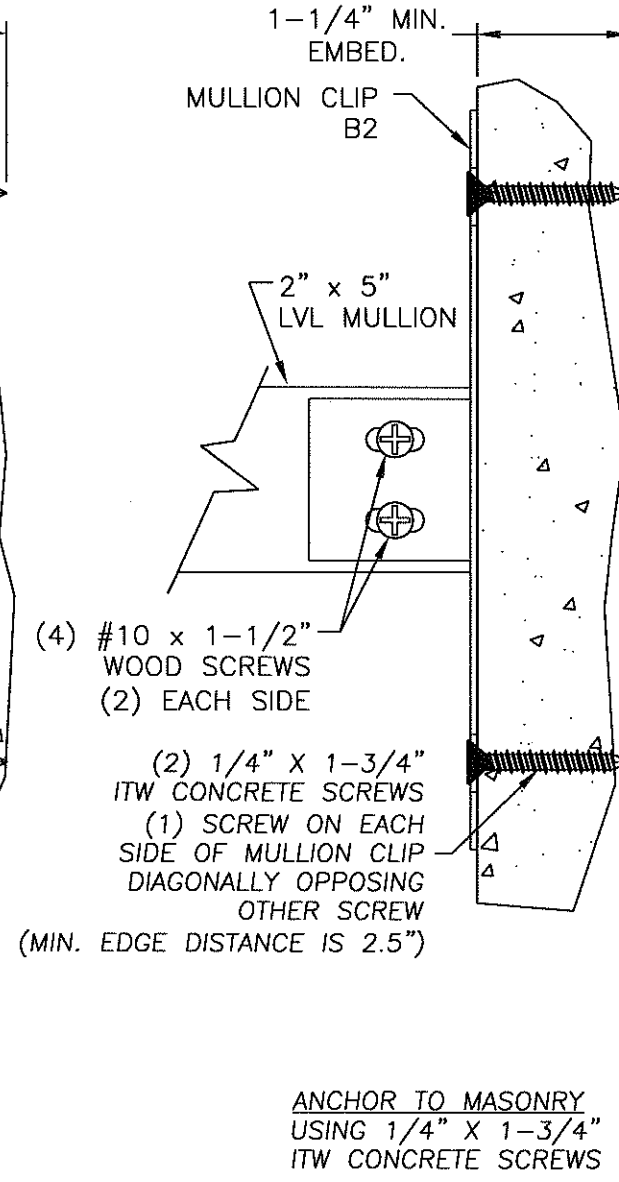
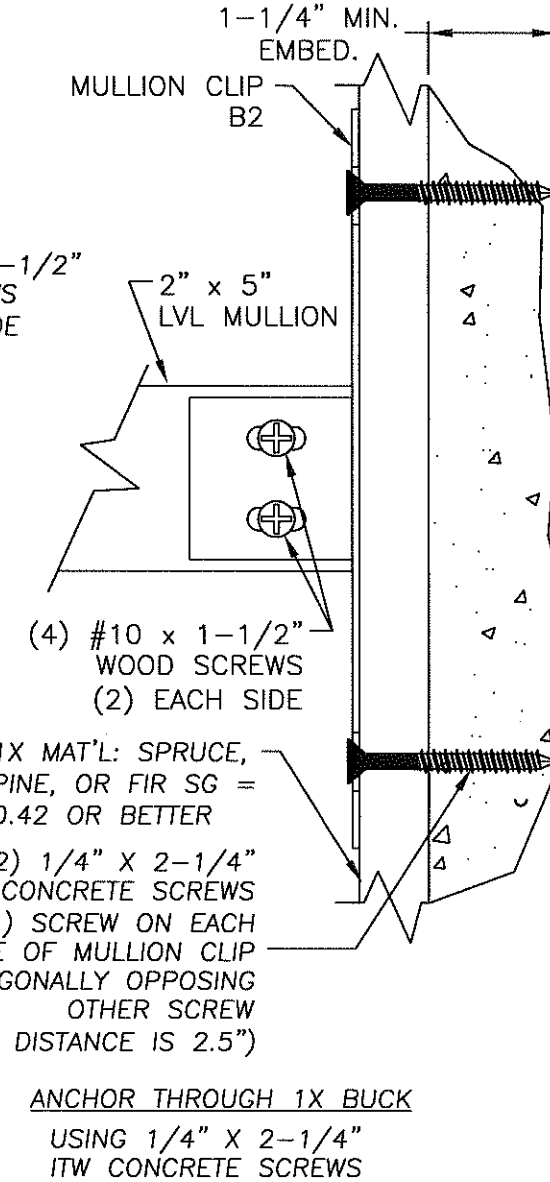
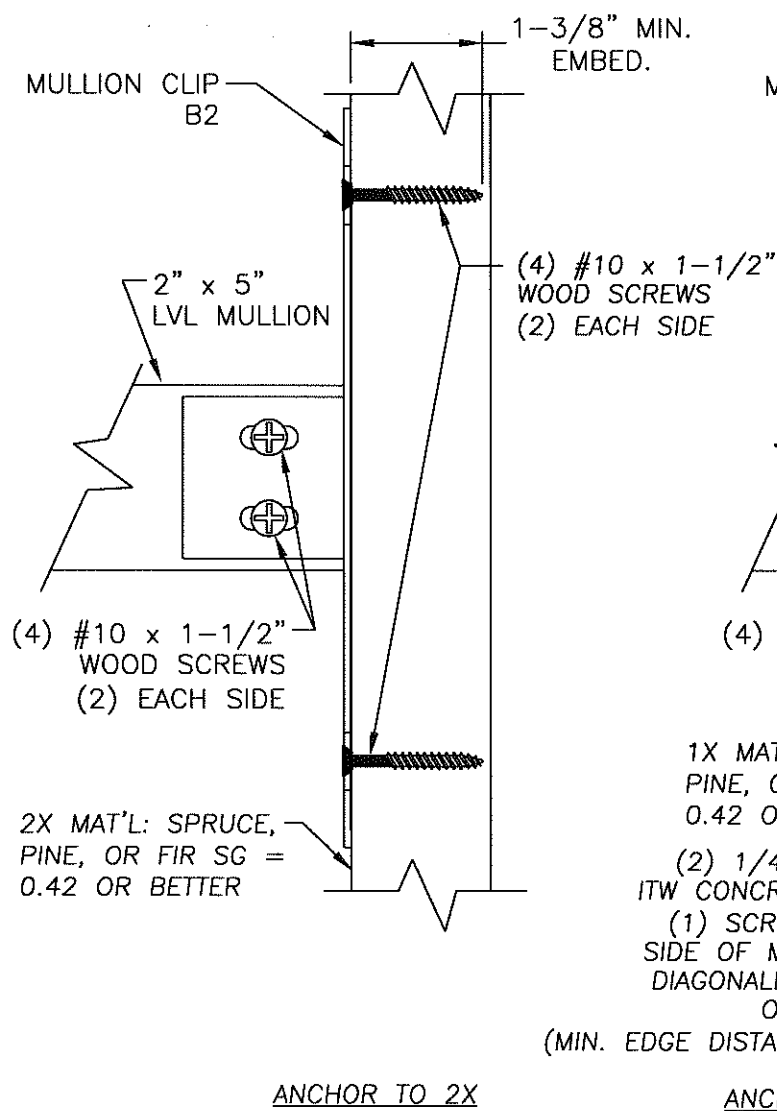
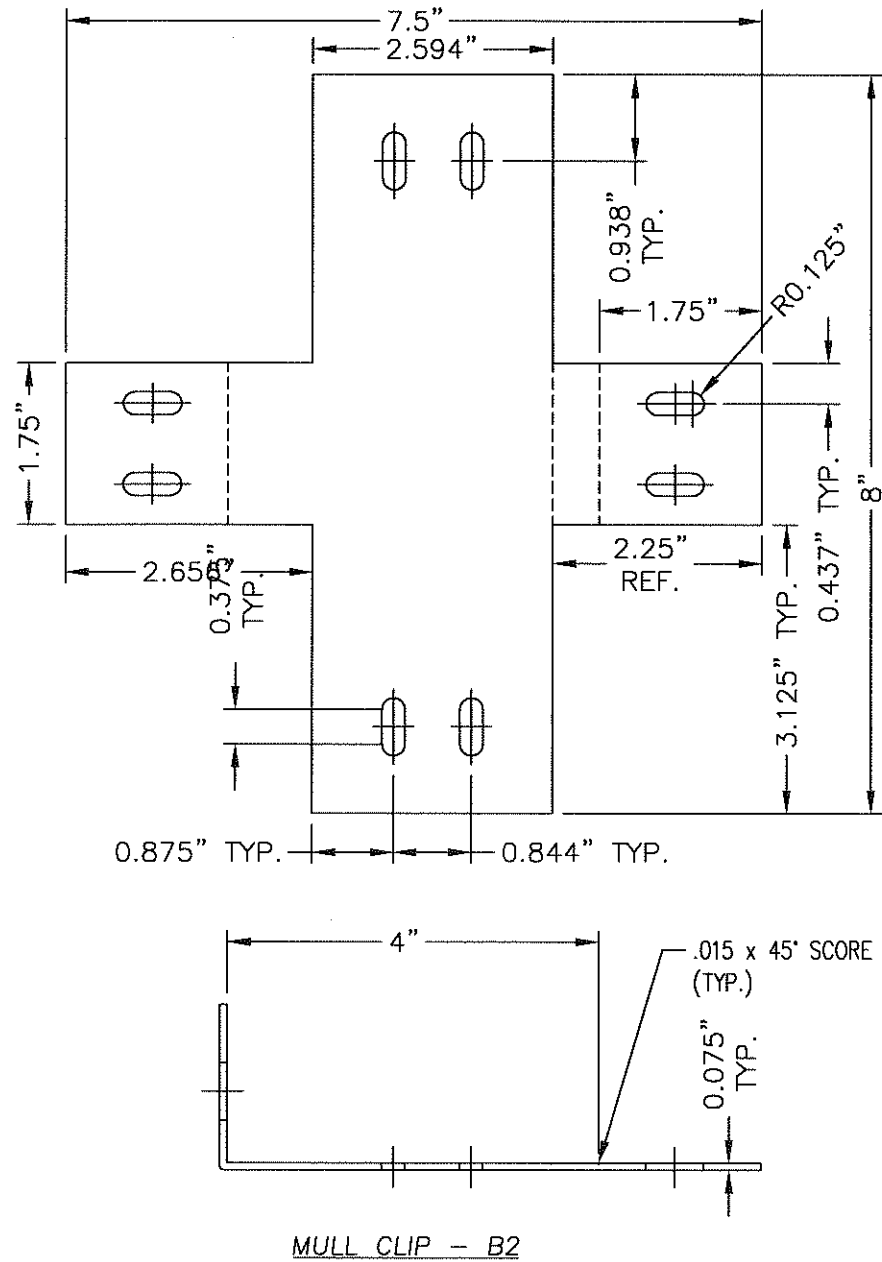
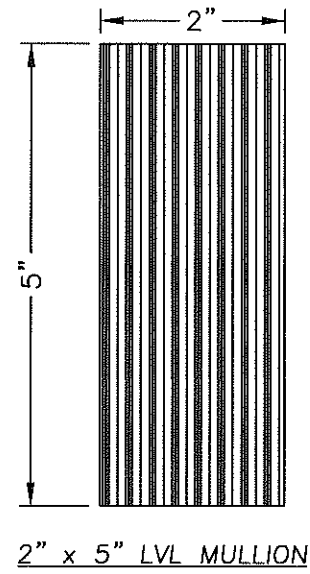

Documents Prepared By:
RW BUILDING CONSULTANTS, INC.
 P.O. Box 230 Vairico FL 33595
 Phone No.: 813.659.9197
 Florida Board of Professional Engineers
 Certificate of Authorization No. 9813
Wendell W. Hapley 9-9-08
 Wendell W. Hapley, P.E. #54158

PRODUCT: STRUCTURAL MULLION
 PART OR ASSEMBLY: ANCHOR CLIP B2 ANCHORING DETAILS

NO.	DATE	REV.	TO THE 2007 FBC	WH	BY
1	9-9-08				

REVISIONS

DATE: 12/04/07
 SCALE: NTS
 DWG. BY: YV
 CHG. BY: WWH
 DRAWING NO.: FL-8566.7
 SHEET 8 OF 9

R:\A - Projects\Project Folders\Proj 1301-1400\PF 1324\D. RWBC Drawings\FL-8566 R1\FL-8566.7\FL-8566.7-9.dwg, Model

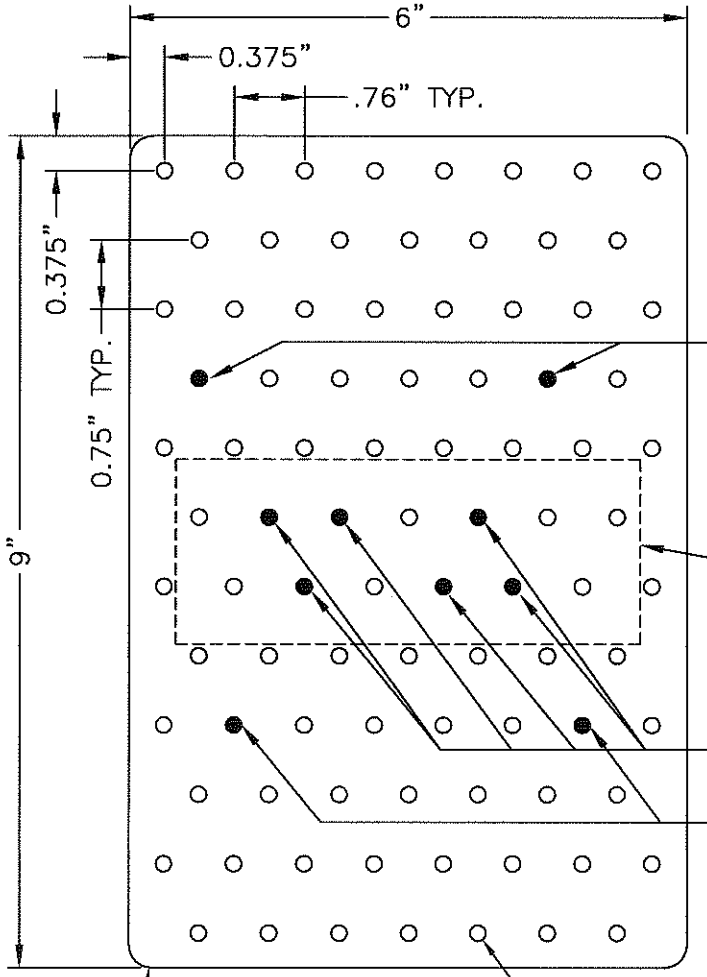
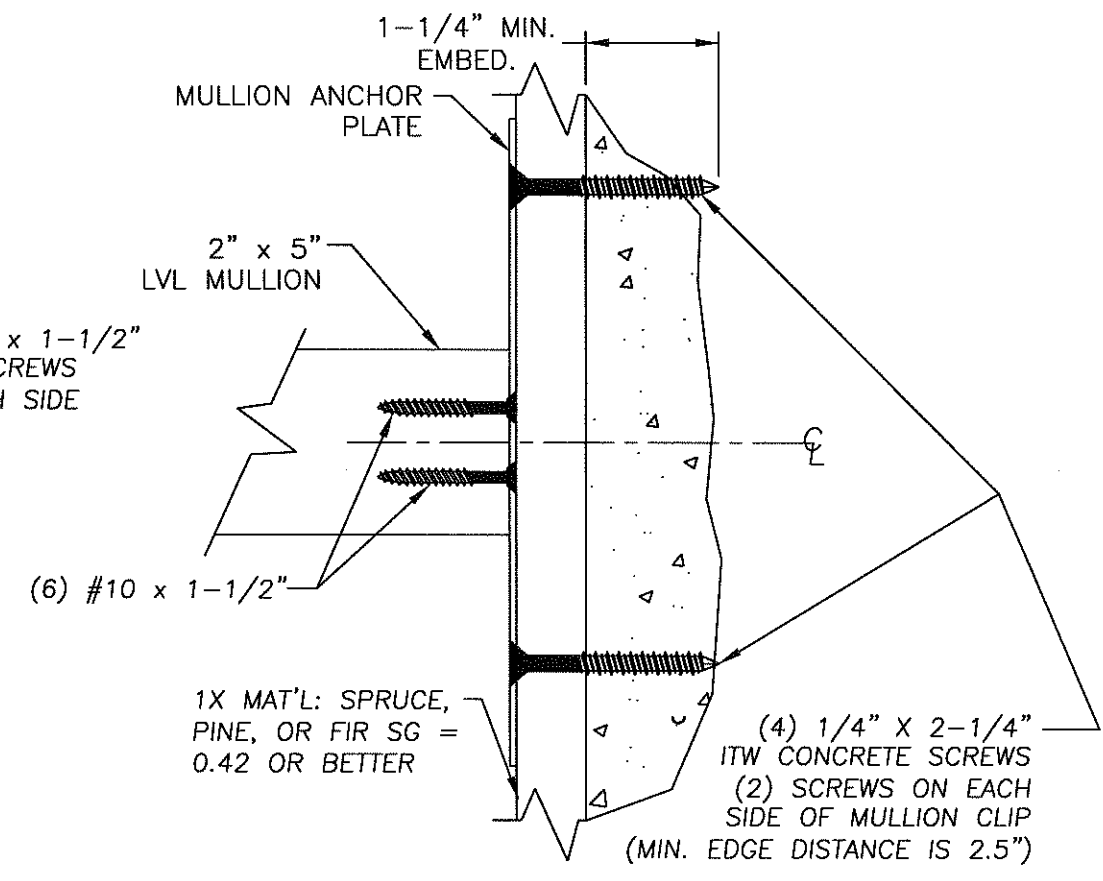
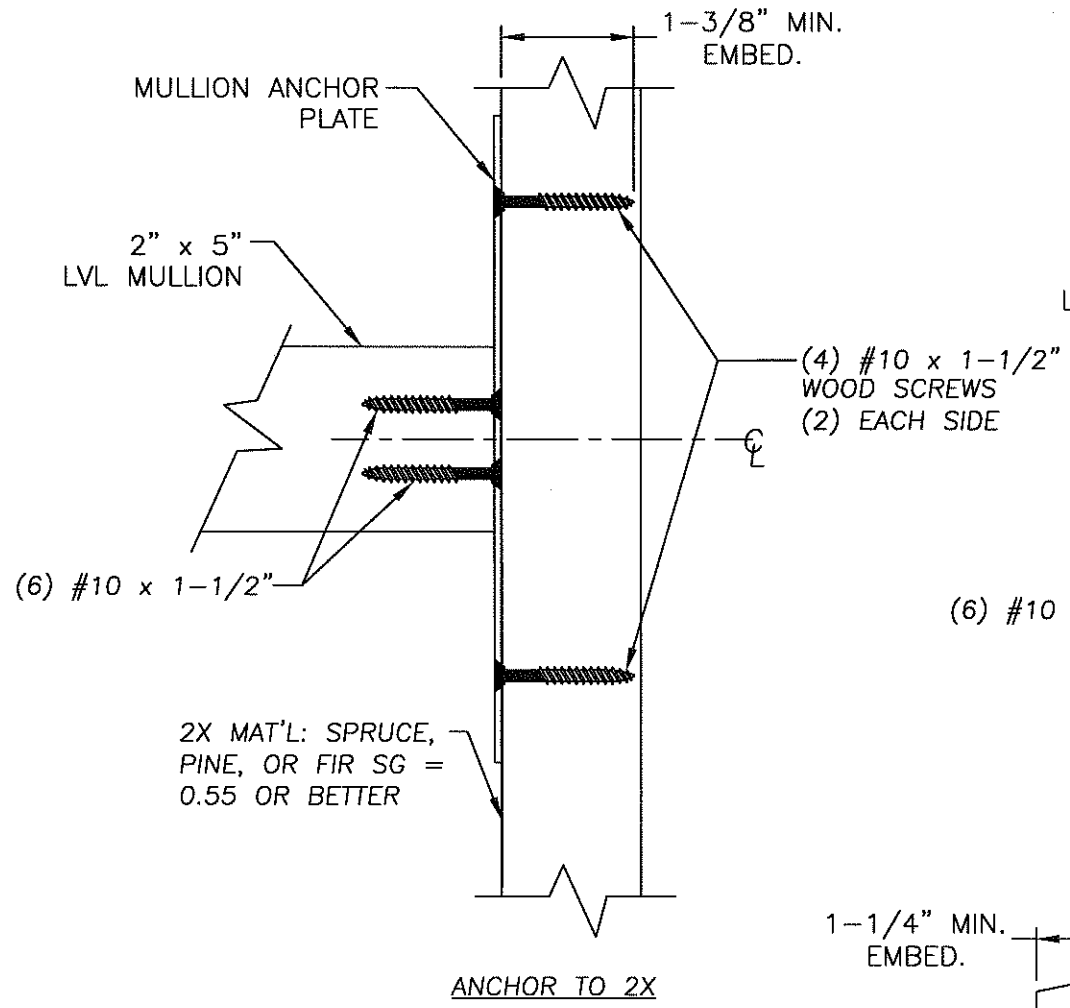
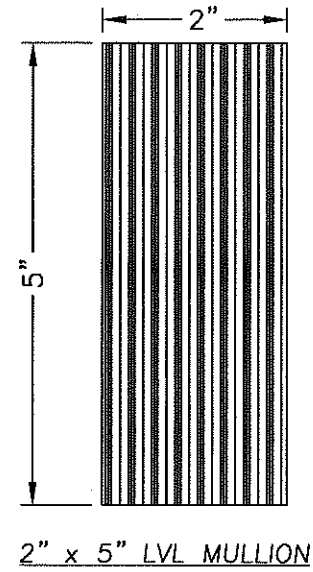

MULLION ANCHOR PLATE
STAINLESS STEEL

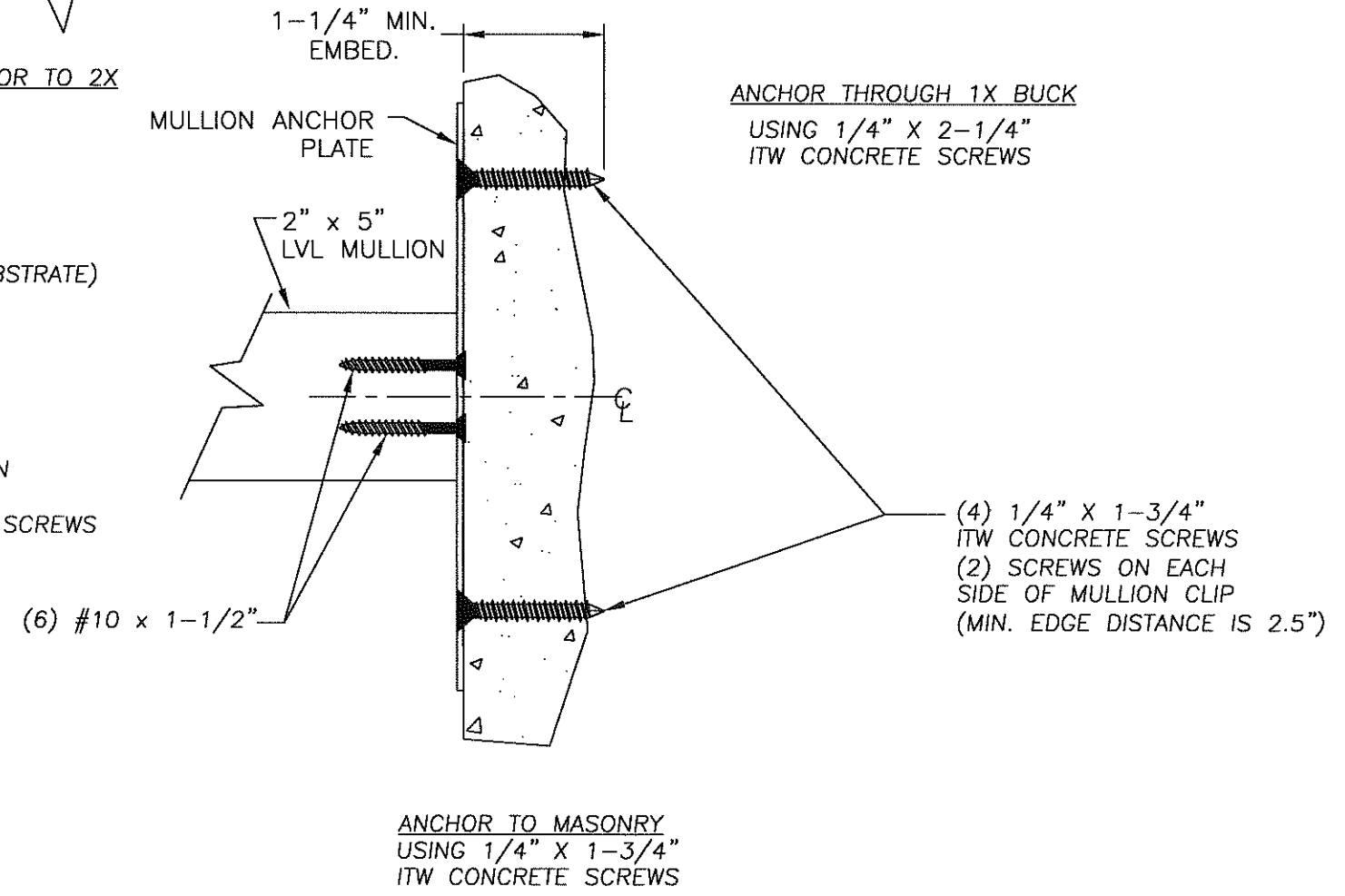

Documents Prepared By:
RW BUILDING CONSULTANTS, INC.
 P.O. Box 230 Valrico FL 33595
 Phone No.: 813.659.9197
 Florida Board of Professional Engineers
 Certificate of Authorization No. 9813
Wendell W. Hensley 9.9.08
 Wendell W. Hensley, P.E. #54158

PRODUCT:		STRUCTURAL MULLION	
PART OR ASSEMBLY:		MULLION ANCHOR PLATE ANCHORING DETAILS	
NO.	DATE	WH	BY
1	9-9-08	REV. TO THE 2007 FBC	
REVISIONS			
DATE: 12/04/07			
SCALE: NTS			
DWG. BY: YV			
CHG. BY: WWH			
DRAWING NO.: FL-8566.7			
SHEET 9 OF 9			